



METCALFE COURT SE10
3 bedroom apartment

£2,500.00
LET



METCALFE COURT SE10

Situated in the popular Greenwich Millennium Village development in North Greenwich, John Harrison Way SE10. Set on the Second floor, this bright and airy three bedroom apartment is offered in immaculate condition after recent refurbishments. The property comprises of a stylish kitchen dinner and a spacious lounge with access to a balcony looking over the landscaped garden, Two large double bedrooms, one with an en-Suite. A smaller third room ideal for an office and a separate modern bathroom. Further benefits include ample storage, two parking spaces and concierge services. The development boasts fantastic connections by way of North Greenwich tube station (Jubilee Line) and the Emirates Cable Cars and enjoys the selection of attractions within the O2. Viewing highly recommended. NO HMO

Borough: Royal Greenwich* Council Tax: C* EPC: TBA Tenancy Deposit: £2,885 24+ Month AST Offered

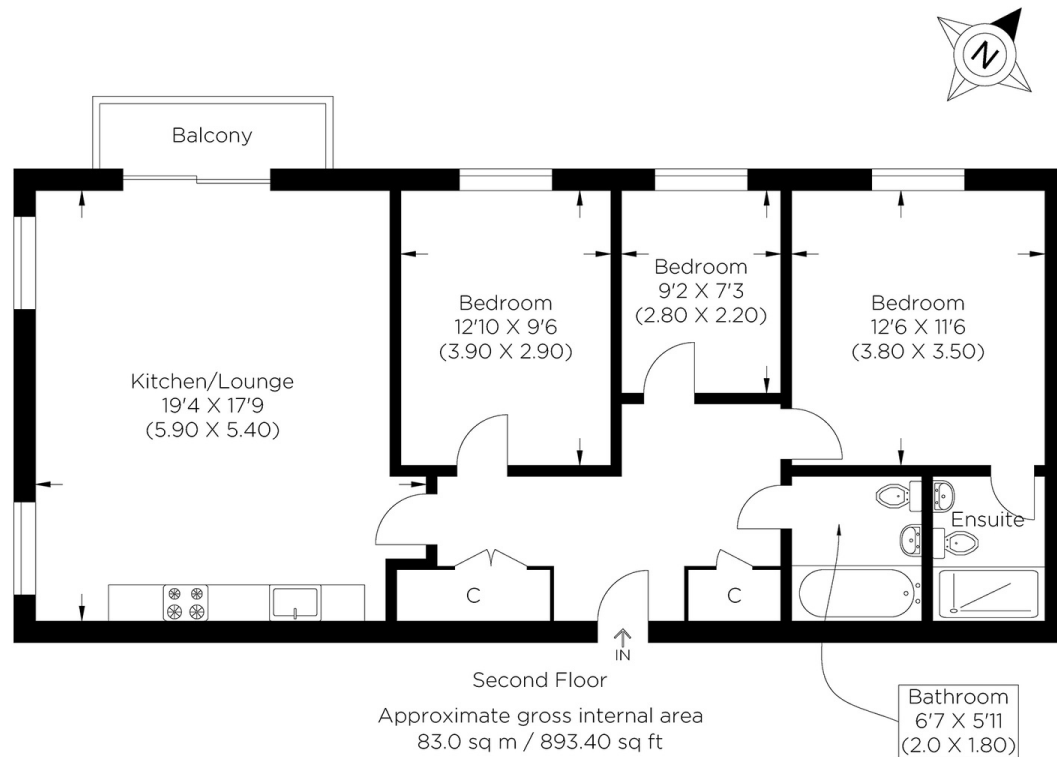

t: 020 8075 9039 e: lettings@alexneil.com

Disclaimer: Property descriptions are subjective and used in good faith as an opinion rather than statements of fact. The owner provided information relating to title, tenure, service charges and ground rent information. Therefore, please make specific enquiries to ensure that our descriptions match your expectations of the property. Floor plan measurements are approximate and for illustrative purposes only. Furthermore, we have not tested any services, systems or appliances at this property. And we strongly recommend that you verify all the provided information on inspection and that your surveyor and conveyancer further confirm details. Also, market conditions and property values regularly fluctuate. And showcased sold properties demonstrate our previous successes rather than indicate live property values. *As advised by the owner. **Property sold subject to contract.



ALEX NEIL

ESTATE AGENTS SINCE 1984