



INWEN COURT SE8
2 bedroom apartment

£1,500.00
LET



INWEN COURT SE8

A well presented first floor two double bedroom flat within popular Grinstead Road, Deptford SE8 development . The property comprises of entrance hall, a reception room, a recently fitted kitchen, two double bedrooms and a white bathroom suite. The property also benefits from double glazing and residents parking. Inwen Court sits on Grinstead Road, opposite Deptford Park, which is well placed less than a mile from Canada Water Jubilee Line station (one stop Canary Wharf) and Surrey Quays London Overground station. Historic Greenwich is a similar distance which boasts an abundance of restaurants and famous Sunday Market.

Borough: Lewisham* Council Tax: C* EPC: D Tenancy Deposit: £1,731 24+ Month AST Offered

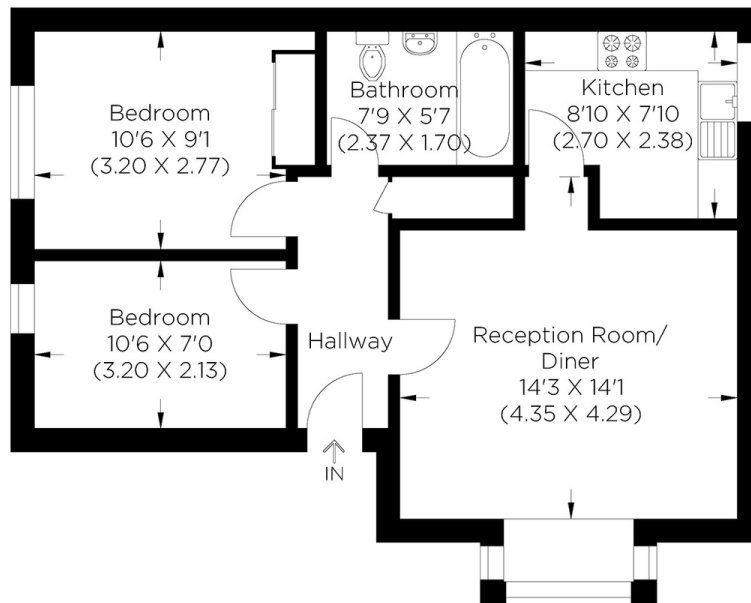

First Floor

Approximate gross internal area
51.40 sq m / 553.26 sq ft



Disclaimer: Property descriptions are subjective and used in good faith as an opinion rather than statements of fact. The owner provided information relating to title, tenure, service charges and ground rent information. Therefore, please make specific enquiries to ensure that our descriptions match your expectations of the property. Floor plan measurements are approximate and for illustrative purposes only. Furthermore, we have not tested any services, systems or appliances at this property. And we strongly recommend that you verify all the provided information on inspection and that your surveyor and conveyancer further confirm details. Also, market conditions and property values regularly fluctuate. And showcased sold properties demonstrate our previous successes rather than indicate live property values. *As advised by the owner. **Property sold subject to contract.

t: 020 8075 9039 e: lettings@alexneil.com

ALEX NEIL

ESTATE AGENTS SINCE 1984