



TELEGRAPH PLACE E14  
**1 bedroom apartment**

**£1,350.00**  
LET





# TELEGRAPH PLACE E14

A beautiful one bedroom apartment offering a light and airy interior throughout set within Telegraph Place, Canary Wharf, E14. This fantastic property is comprised of a spacious reception room with tasteful decor, a modern fitted kitchen, generous double bedroom and a stylish bathroom, all recently refurbished! Telegraph Place is set in a pleasant residential close to the picturesque Millwall Dock and to Mudchute Park, while Canary Wharf with its plethora of shops, bars and restaurants is within easy reach. This property also enjoys fantastic transport links by way of Mudchute DLR station and bus services and a parking space. Early viewing is highly recommended.

Borough: Tower Hamlets\* Council Tax: C\* EPC: C Tenancy Deposit: £1,558 24+ Month AST Offered

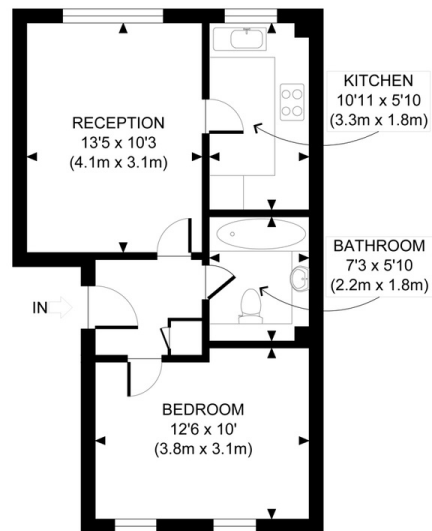

SECOND FLOOR  
GROSS INTERNAL  
FLOOR AREA 416 SQ FT

APPROX. GROSS INTERNAL FLOOR AREA 416 SQ FT / 39 SQM

t: 020 8075 9039 e: [lettings@alexneil.com](mailto:lettings@alexneil.com)

Disclaimer: Property descriptions are subjective and used in good faith as an opinion rather than statements of fact. The owner provided information relating to title, tenure, service charges and ground rent information. Therefore, please make specific enquiries to ensure that our descriptions match your expectations of the property. Floor plan measurements are approximate and for illustrative purposes only. Furthermore, we have not tested any services, systems or appliances at this property. And we strongly recommend that you verify all the provided information on inspection and that your surveyor and conveyancer further confirm details. Also, market conditions and property values regularly fluctuate. And showcased sold properties demonstrate our previous successes rather than indicate live property values. \*As advised by the owner. \*\*Property sold subject to contract.



# ALEX NEIL

ESTATE AGENTS SINCE 1984