



ORION POINT E14
2 bedroom apartment

£500,000
LEASEHOLD



ORION POINT E14

We present this spacious two-bedroom sixth-floor apartment in the desirable Orion Point on Crews Street in Isle of Dogs E14, part of the revered Odyssey development. This beautiful riverside property features breathtaking views over the River Thames and The City skyline. The accommodation comprises a large lounge with a semi-open plan kitchen, two large bedrooms and two bathrooms. There is abundant storage and a private balcony. Residents of The Odyssey enjoy concierge services, leisure facilities and parking. We highly recommend your earliest viewing of this stunning home.

Borough: Tower Hamlets* Council Tax: F* EPC: B Lease Term: 99 years* Service Charge: £6,500* Ground Rent: £300*
Nearest Station: Mudchute (0.48 miles) Material Information: www.alexneil.com/material-information

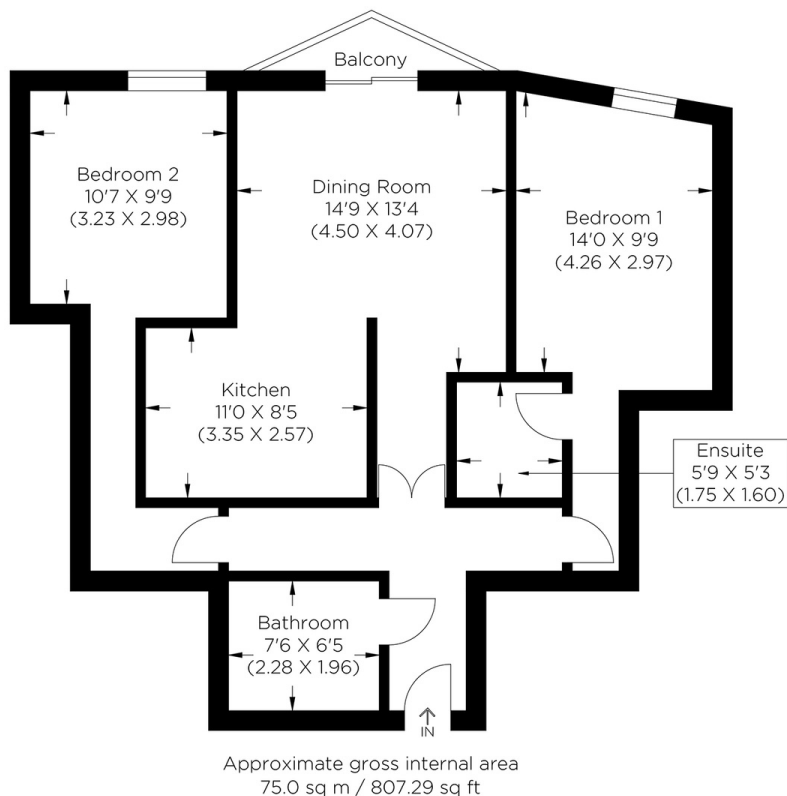

Canary Wharf & Docklands Office
2 Westferry Road, Canary Wharf, London E14 8JT

t: 020 7537 9859 e: sales@alexneil.com

Disclaimer: Property descriptions are subjective and used in good faith as an opinion rather than statements of fact. The owner provided information relating to title, tenure, service charges and ground rent information. Therefore, please make specific enquiries to ensure that our descriptions match your expectations of the property. Floor plan measurements are approximate and for illustrative purposes only. Furthermore, we have not tested any services, systems or appliances at this property. And we strongly recommend that you verify all the provided information on inspection and that your surveyor and conveyancer further confirm details. Also, market conditions and property values regularly fluctuate. And showcased sold properties demonstrate our previous successes rather than indicate live property values. *As advised by the owner. **Property sold subject to contract.



ALEX NEIL

ESTATE AGENTS SINCE 1984