



LIME KILN WHARF E14  
**1 bedroom apartment**

**£400,000+**

SHARE OF  
FREEHOLD





# LIME KILN WHARF E14

We are pleased to offer this one bedroom apartment, set within Lime Kiln Wharf, Three Colt Street, E14, a secure gated development. The apartment provides an entrance hallway, a spacious reception room and master bedroom both accessing a private balcony offering views towards river inlet, a separate kitchen and contemporary bathroom. This property also benefits from an allocated secure parking space. Located just behind the ever popular Narrow Street, communal gardens, terrace and lift access make the development a wonderful place to live, with several of the areas best riverside restaurants and bars within close walking distance. Westferry DLR is just a few minutes walk away allowing for quick and easy access into The City and Canary Wharf. Canary Wharf itself is just a short stroll away offering a vast choice of bars, shops, supermarkets and restaurants. An early viewing comes highly recommended.

Borough: Tower Hamlets\* Council Tax: D\* EPC: D Lease Term: 90 years\* Service Charge: £3,700\* Ground Rent: TBA  
Nearest Station: Westferry (0.15 miles) Material Information: [www.alexneil.com/material-information](http://www.alexneil.com/material-information)

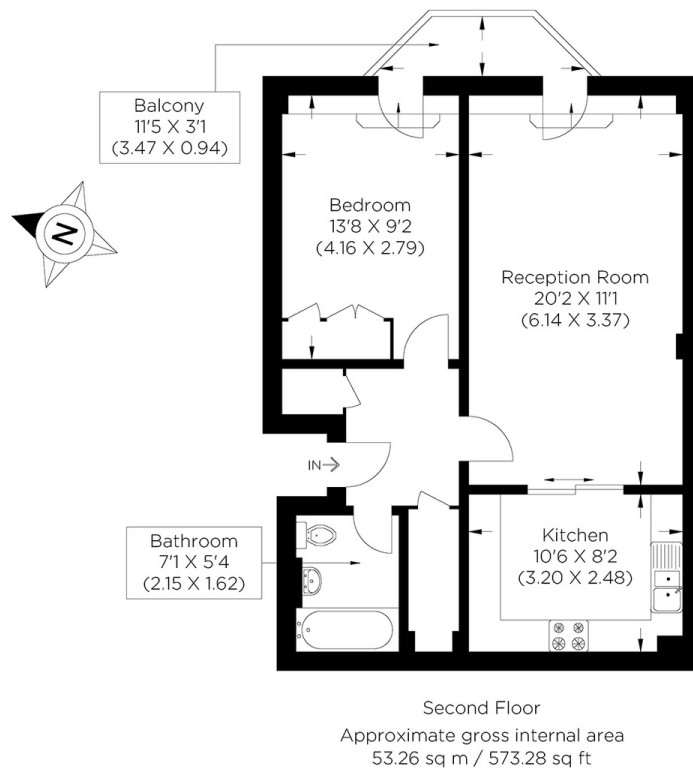

**Canary Wharf & Docklands Office**  
**2 Westferry Road, Canary Wharf, London E14 8JT**

Disclaimer: Property descriptions are subjective and used in good faith as an opinion rather than statements of fact. The owner provided information relating to title, tenure, service charges and ground rent information. Therefore, please make specific enquiries to ensure that our descriptions match your expectations of the property. Floor plan measurements are approximate and for illustrative purposes only. Furthermore, we have not tested any services, systems or appliances at this property. And we strongly recommend that you verify all the provided information on inspection and that your surveyor and conveyancer further confirm details. Also, market conditions and property values regularly fluctuate. And showcased sold properties demonstrate our previous successes rather than indicate live property values. \*As advised by the owner. \*\*Property sold subject to contract.

t: 020 7537 9859 e: [sales@alexneil.com](mailto:sales@alexneil.com)



# ALEX NEIL

ESTATE AGENTS SINCE 1984