



TAFFRAIL HOUSE E14  
**1 bedroom apartment**

**£320,000**

SHARE OF  
FREEHOLD





# TAFFRAIL HOUSE E14

Newly decorated and chain-free, this spacious one-bedroom flat is located in the highly desirable Taffrail House within Burrells Wharf, E14. Set in a historic riverside development, the property offers modern living with a generous, light-filled living area, a well-sized bedroom with ample storage, and a fitted kitchen and bathroom with classic finishes. The home is move-in ready and ideal for professionals, first-time buyers, or investors. Residents benefit from a secure, a secure underground parking space and access to excellent on-site leisure facilities, including a gym, swimming pool, and communal gardens. The development also features a 24-hour concierge service and is just moments from the River Thames, with Canary Wharf a short distance away. With strong transport links, riverside walks, and vibrant local amenities nearby, this is a rare opportunity to own a quality property in one of East London's most attractive and well-maintained communities

Borough: Tower Hamlets\* Council Tax: D\* EPC: TBA Lease Term: 88 years\* Service Charge: £4,818\* Ground Rent: £50\*

Nearest Station: Mudchute (0.33 miles) Material Information: [www.alexneil.com/material-information](http://www.alexneil.com/material-information)

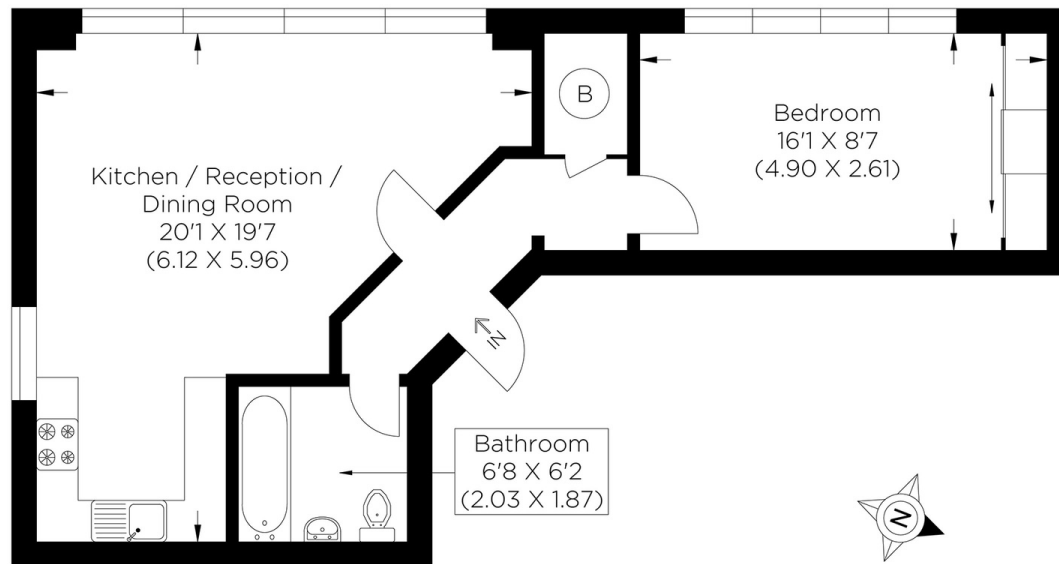

First Floor

Approximate gross internal area  
48.50 sq m / 522.04 sq ft

## Canary Wharf & Docklands Office

2 Westferry Road, Canary Wharf, London E14 8JT

Disclaimer: Property descriptions are subjective and used in good faith as an opinion rather than statements of fact. The owner provided information relating to title, tenure, service charges and ground rent information. Therefore, please make specific enquiries to ensure that our descriptions match your expectations of the property. Floor plan measurements are approximate and for illustrative purposes only. Furthermore, we have not tested any services, systems or appliances at this property. And we strongly recommend that you verify all the provided information on inspection and that your surveyor and conveyancer further confirm details. Also, market conditions and property values regularly fluctuate. And showcased sold properties demonstrate our previous successes rather than indicate live property values. \*As advised by the owner. \*\*Property sold subject to contract.

t: 020 7537 9859 e: [sales@alexneil.com](mailto:sales@alexneil.com)



# ALEX NEIL

ESTATE AGENTS SINCE 1984