



KILN COURT E14
2 bedroom apartment

£400,000+
SOLD STC**



KILN COURT E14

Situated within this purpose built block, is this spacious split level two bedroom apartment. Located within the picturesque area of Limehouse. This property comprises (first floor) entrance hall, fitted kitchen and reception room, both offering access to external terrace. (second floor) two double bedrooms and family bathroom. The development offers communal gardens & children's play area and is moments away from the river Thames and nearby amenities including the Limehouse Marina and the many eateries of Narrow Street. Ropemakers field park & Westferry DLR station is within minutes walk allowing easy access into the Canary Wharf business complex being only two stops away. Properties within this location are always in high demand and we would highly recommend an immediate viewing.

Borough: Tower Hamlets* Council Tax: C* EPC: C Lease Term: 89 years* Service Charge: £3,100* Ground Rent: £10*
Nearest Station: Westferry (0.24 miles) Material Information: www.alexneil.com/material-information

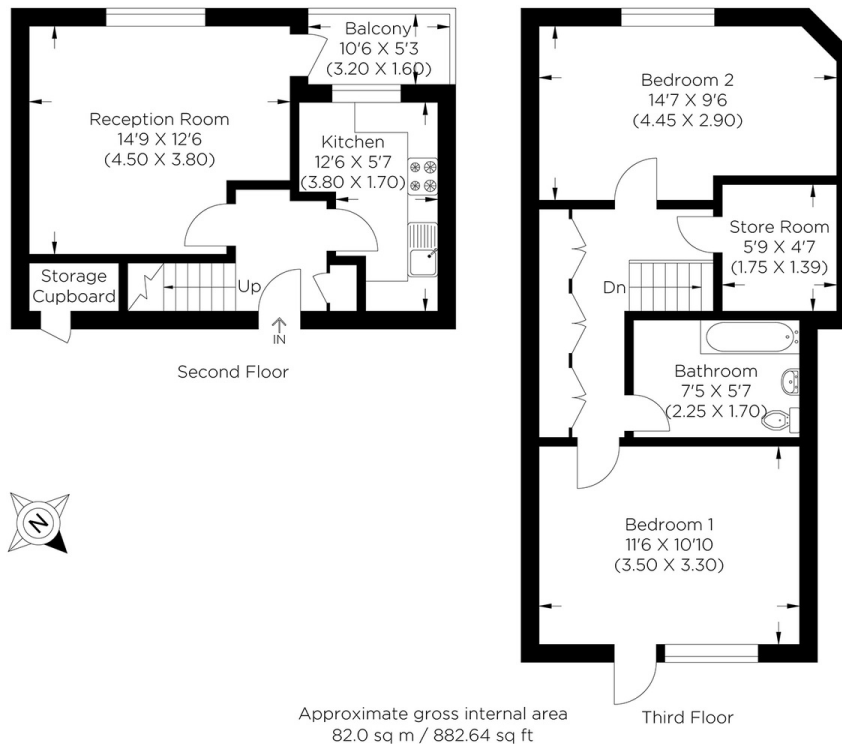

Canary Wharf & Docklands Office
2 Westferry Road, Canary Wharf, London E14 8JT

t: 020 7537 9859 e: sales@alexneil.com

Disclaimer: Property descriptions are subjective and used in good faith as an opinion rather than statements of fact. The owner provided information relating to title, tenure, service charges and ground rent information. Therefore, please make specific enquiries to ensure that our descriptions match your expectations of the property. Floor plan measurements are approximate and for illustrative purposes only. Furthermore, we have not tested any services, systems or appliances at this property. And we strongly recommend that you verify all the provided information on inspection and that your surveyor and conveyancer further confirm details. Also, market conditions and property values regularly fluctuate. And showcased sold properties demonstrate our previous successes rather than indicate live property values. *As advised by the owner. **Property sold subject to contract.

ALEX NEIL

ESTATE AGENTS SINCE 1984