



ADVENTURERS COURT E14  
**1 bedroom apartment**

**£330,000**  
LEASEHOLD





# ADVENTURERS COURT E14

We present a stunning one-bedroom apartment in Adventurers Court on Newport Avenue, part of the popular Virginia Quay development beside the River Thames in Docklands E14. The property boasts a modernised bathroom, a double bedroom, a large reception room, a separate kitchen, a balcony with views of the City and an underground parking space for convenience. Virginia Quay Fetutres concierge services and East India DLR station are just a few minutes walk away, making it easy to commute into Canary Wharf and the City via the Jubilee and Elizabeth Line Crossrail stations. Canary Wharf's business district and shopping plazas are a 10-15 minute walk away, where you can enjoy various shops, cafes, restaurants and bars in beautiful contemporary settings.

Borough: Tower Hamlets\* Council Tax: C\* EPC: C Lease Term: 900 years\* Service Charge: £3,500\* Ground Rent: £250\*  
Nearest Station: East India (0.1 miles) Material Information: [www.alexneil.com/material-information](http://www.alexneil.com/material-information)

Approximate Gross Internal Area  
50.41 sq m / 542.61 sq ft

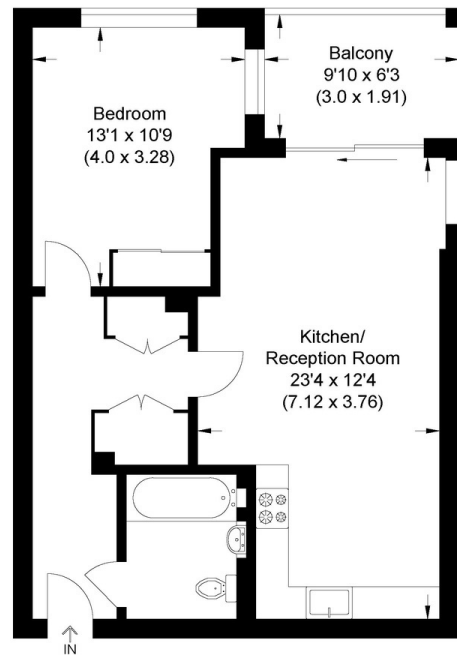

Illustration for identification purposes only, measurements are approximate, not to scale.

**Canary Wharf & Docklands Office**  
2 Westferry Road, Canary Wharf, London E14 8JT

t: 020 7537 9859 e: [sales@alexneil.com](mailto:sales@alexneil.com)

Disclaimer: Property descriptions are subjective and used in good faith as an opinion rather than statements of fact. The owner provided information relating to title, tenure, service charges and ground rent information. Therefore, please make specific enquiries to ensure that our descriptions match your expectations of the property. Floor plan measurements are approximate and for illustrative purposes only. Furthermore, we have not tested any services, systems or appliances at this property. And we strongly recommend that you verify all the provided information on inspection and that your surveyor and conveyancer further confirm details. Also, market conditions and property values regularly fluctuate. And showcased sold properties demonstrate our previous successes rather than indicate live property values. \*As advised by the owner. \*\*Property sold subject to contract.

# ALEX NEIL

ESTATE AGENTS SINCE 1984