



LANTERNA COURT E3  
**1 bedroom apartment**

**£475,000**  
LEASEHOLD





# LANTERNA COURT E3

We are delighted to offer the market this beautifully presented modern apartment in Lanterna Court, Wyke Road, Hackney Wick, E3. This third-floor apartment forms part of an impressive canal-side development. The property has been finished to a very high standard and features a high-spec kitchen, underfloor heating, wood flooring and a private balcony. Residents of the development enjoy access to a concierge service, gymnasium, lift access to all floors and secure underground bike storage. Ever so popular, Hackney Wick has something for everyone, including excellent transport links. Lanterna Court is a short walk from Stratford and Westfield, plus a wide selection of coffee shops, bars and restaurants. This property is chain-free, and we highly recommend your earliest viewing.

Borough: Tower Hamlets\* Council Tax: C\* EPC: B Lease Term: 245 years\* Service Charge: £2,640\* Ground Rent: £300\*  
Nearest Station: Hackney Wick (0.21 miles) Material Information: [www.alexneil.com/material-information](http://www.alexneil.com/material-information)

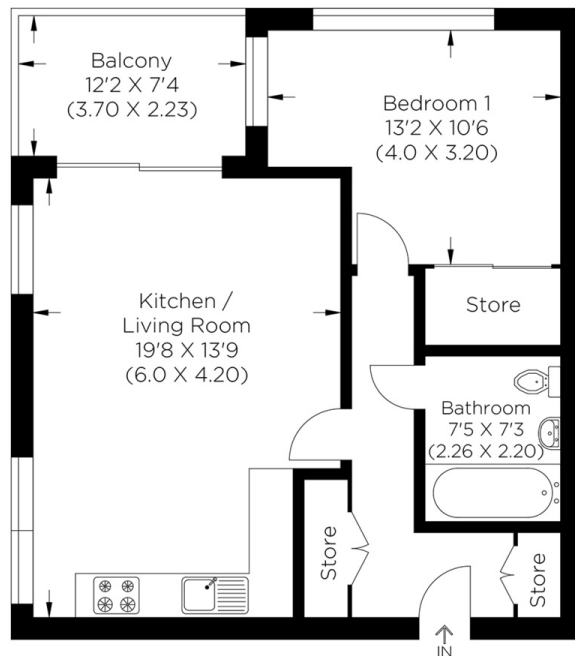

Third Floor

Approximate gross internal area  
51.0 sq m / 548.95 sq ft



**Canary Wharf & Docklands Office**  
2 Westferry Road, Canary Wharf, London E14 8JT

t: 020 7537 9859 e: [canarywharf@alexneil.com](mailto:canarywharf@alexneil.com)

Disclaimer: Property descriptions are subjective and used in good faith as an opinion rather than statements of fact. The owner provided information relating to title, tenure, service charges and ground rent information. Therefore, please make specific enquiries to ensure that our descriptions match your expectations of the property. Floor plan measurements are approximate and for illustrative purposes only. Furthermore, we have not tested any services, systems or appliances at this property. And we strongly recommend that you verify all the provided information on inspection and that your surveyor and conveyancer further confirm details. Also, market conditions and property values regularly fluctuate. And showcased sold properties demonstrate our previous successes rather than indicate live property values. \*As advised by the owner. \*\*Property sold subject to contract.

# ALEX NEIL

ESTATE AGENTS SINCE 1984

2024 signifies our **40th Anniversary**, and we are immensely proud to have reached this impressive longevity milestone. In celebration, we launched an **exceptional promotion** for sellers, affording them increased marketing exposure for free!

**40 years of expertise:** With four decades of experience, we bring a wealth of knowledge and expertise. Our durability is a testament to the trust satisfied clients place in us. We understand the nuances of the diverse neighbourhoods we cover. Our local expertise allows us to provide tailored solutions, whether you're buying or selling, allowing you to move with confidence.



ALEX NEIL

ESTATE AGENTS SINCE 1984

[www.alexneil.com](http://www.alexneil.com)