



FISHER CLOSE SE16
1 bedroom apartment

£375,000+
LEASEHOLD



FISHER CLOSE SE16

We present an immaculate, rare-to-the-market one-bedroom apartment in the desirable Fisher Close, Rotherhithe SE16. The property is part of the recently completed residential development. This chain-free property comprises a large and bright open-plan kitchen-living room with a smartly fitted kitchen with fully integrated appliances, a generous bedroom, and a contemporary three-piece bathroom. This fantastic property also provides a large balcony with views over the courtyard, ample storage and plenty of natural light. Fisher Close's perfect location on the Rotherhithe peninsula is within easy reach of Canada Water Jubilee Line, Rotherhithe overground station and the River Bus. Rotherhithe offers a choice of pubs and restaurants with walks along the river and nearby Russia Dock Woodland. We highly recommend viewing this apartment.

Borough: Southwark* Council Tax: D* EPC: A Lease Term: 119 years* Service Charge: £3,012* Ground Rent: £50*
Nearest Station: Rotherhithe (0.49 miles) Material Information: www.alexneil.com/material-information

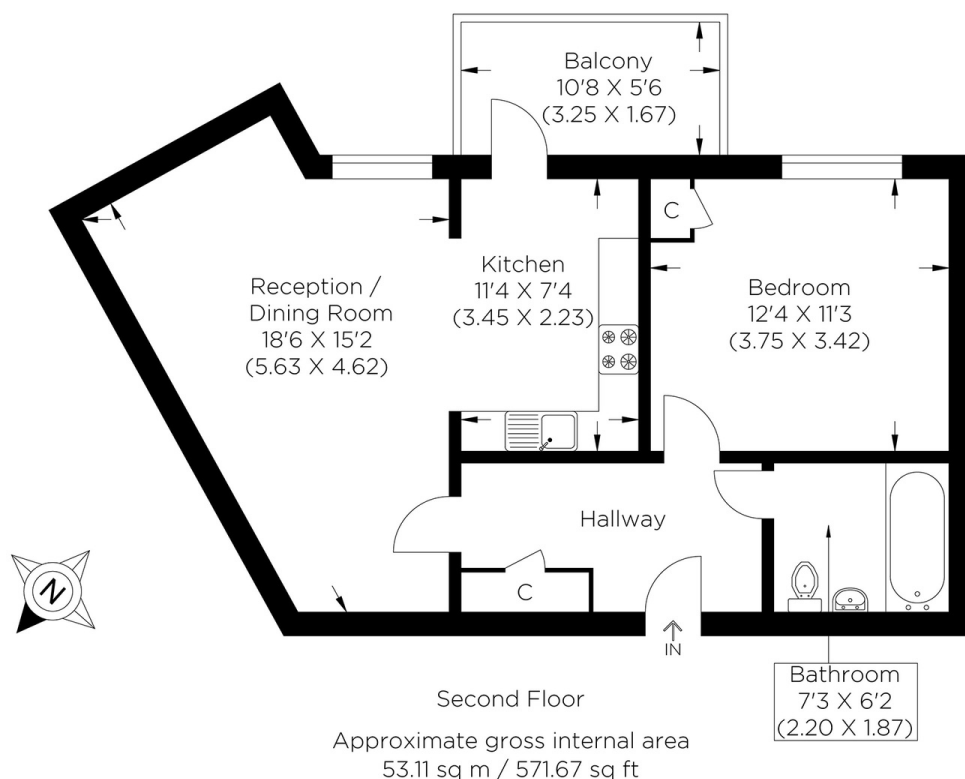

Rotherhithe & Bermondsey Office
146 Lower Road, London SE16 2UG

t: 020 7237 6767 e: rotherhithe@alexneil.com

Disclaimer: Property descriptions are subjective and used in good faith as an opinion rather than statements of fact. The owner provided information relating to title, tenure, service charges and ground rent information. Therefore, please make specific enquiries to ensure that our descriptions match your expectations of the property. Floor plan measurements are approximate and for illustrative purposes only. Furthermore, we have not tested any services, systems or appliances at this property. And we strongly recommend that you verify all the provided information on inspection and that your surveyor and conveyancer further confirm details. Also, market conditions and property values regularly fluctuate. And showcased sold properties demonstrate our previous successes rather than indicate live property values. *As advised by the owner. **Property sold subject to contract.

ALEX NEIL

ESTATE AGENTS SINCE 1984

2024 signifies our **40th Anniversary**, and we are immensely proud to have reached this impressive longevity milestone. In celebration, we launched an **exceptional promotion** for sellers, affording them increased marketing exposure for free!

40 years of expertise: With four decades of experience, we bring a wealth of knowledge and expertise. Our durability is a testament to the trust satisfied clients place in us. We understand the nuances of the diverse neighbourhoods we cover. Our local expertise allows us to provide tailored solutions, whether you're buying or selling, allowing you to move with confidence.



ALEX NEIL

ESTATE AGENTS SINCE 1984

www.alexneil.com