



BRINKWORTH WAY E9  
**3 bedroom bungalow**

**£700,000**  
SOLD STC\*\*





# BRINKWORTH WAY E9

This light and bright three-bedroom bungalow is on the quiet, residential Brinkworth Way in Hackney, E9. It boasts excellent entertaining space and a first-class location, and it is available chain-free. The accommodation comprises a reception room with access to a fantastic-sized private garden, a fitted kitchen, a main bedroom, a double guest bedroom, a further guest bedroom, and a family bathroom. Brinkworth Way is an ideal location in the heart of Hackney Wick and is only moments away from the many local bars, restaurants, and coffee houses. It is also a short walk from the wide open spaces of Victoria Park, Hackney Marshes and the Queen Elizabeth Olympic Park. Local transport links include Hackney Wick Station (Overground) and various bus routes into The City & West End.

Borough: Tower Hamlets\* Council Tax: C\* EPC: C

Nearest Station: Hackney Wick (0.18 miles) Material Information: [www.alexneil.com/material-information](http://www.alexneil.com/material-information)

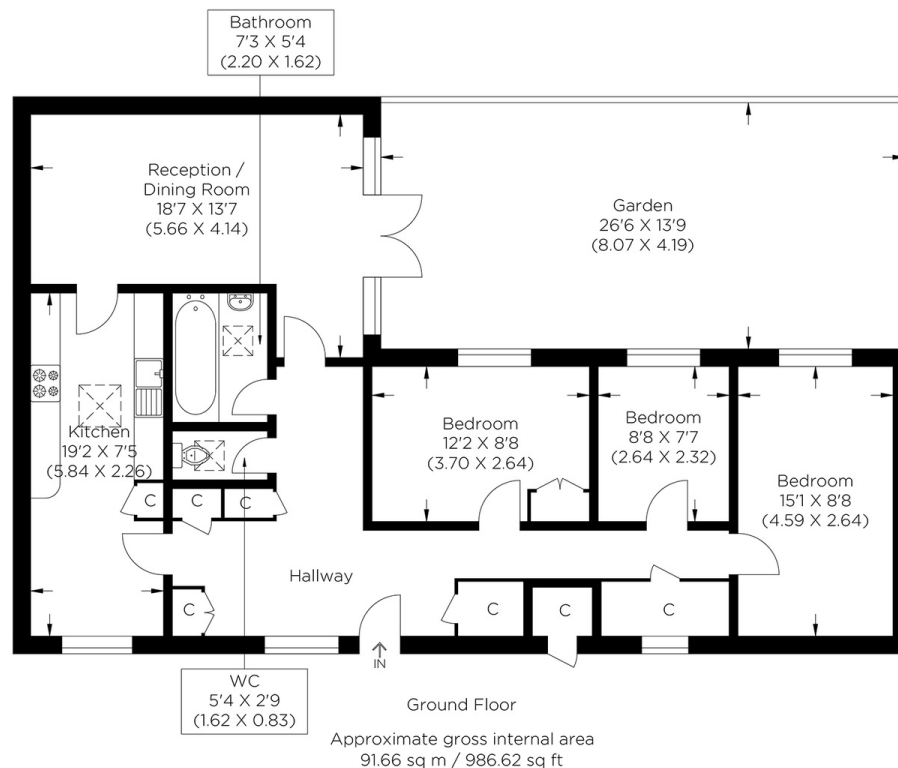

**Canary Wharf & Docklands Office**  
2 Westferry Road, Canary Wharf, London E14 8JT

t: 020 7537 9859 e: [canarywharf@alexneil.com](mailto:canarywharf@alexneil.com)

Disclaimer: Property descriptions are subjective and used in good faith as an opinion rather than statements of fact. The owner provided information relating to title, tenure, service charges and ground rent information. Therefore, please make specific enquiries to ensure that our descriptions match your expectations of the property. Floor plan measurements are approximate and for illustrative purposes only. Furthermore, we have not tested any services, systems or appliances at this property. And we strongly recommend that you verify all the provided information on inspection and that your surveyor and conveyancer further confirm details. Also, market conditions and property values regularly fluctuate. And showcased sold properties demonstrate our previous successes rather than indicate live property values. \*As advised by the owner. \*\*Property sold subject to contract.

**ALEX NEIL**

ESTATE AGENTS SINCE 1984

2024 signifies our **40th Anniversary**, and we are immensely proud to have reached this impressive longevity milestone. In celebration, we launched an **exceptional promotion** for sellers, affording them increased marketing exposure for free!

**40 years of expertise:** With four decades of experience, we bring a wealth of knowledge and expertise. Our durability is a testament to the trust satisfied clients place in us. We understand the nuances of the diverse neighbourhoods we cover. Our local expertise allows us to provide tailored solutions, whether you're buying or selling, allowing you to move with confidence.



ALEX NEIL

ESTATE AGENTS SINCE 1984

[www.alexneil.com](http://www.alexneil.com)