



WHEEL HOUSE E14  
**2 bedroom apartment**

**£700,000+**  
SHARE OF  
FREEHOLD





# WHEEL HOUSE E14

Stylish and elegant throughout, this stunning apartment is presented in pristine condition, situated within the ever-popular Wheel House at Burrells Wharf, E14. Boasting over 1,000 square feet of internal space, the apartment comprises a refurbished galley-style kitchen with integrated Siemens appliances, a large lounge with fitted storage, a master bedroom with generous en-suite and walk-in wardrobe, a second double bedroom, and a family bathroom. The three balconies and floor-to-ceiling windows flood the property with natural light and provide magnificent views. Wheel House is part of the sought-after Burrells Wharf development, offering amenities including a swimming pool, gym, allocated private parking and a 24-hour concierge. Burrells Wharf is ideally located on the Isle of Dogs between the renowned Greenwich and Canary Wharf. A riverboat service operates from Masthouse Terrace Pier next to the development, and Island Gardens and Mudchute DLR stations (Zone 2) are minutes away.

Borough: Tower Hamlets\* Council Tax: E\* EPC: C Lease Term: 999 years\* Service Charge: £10,827\* Ground Rent: £50\*  
 Nearest Station: Mudchute (0.36 miles) Material Information: [www.alexneil.com/material-information](http://www.alexneil.com/material-information)

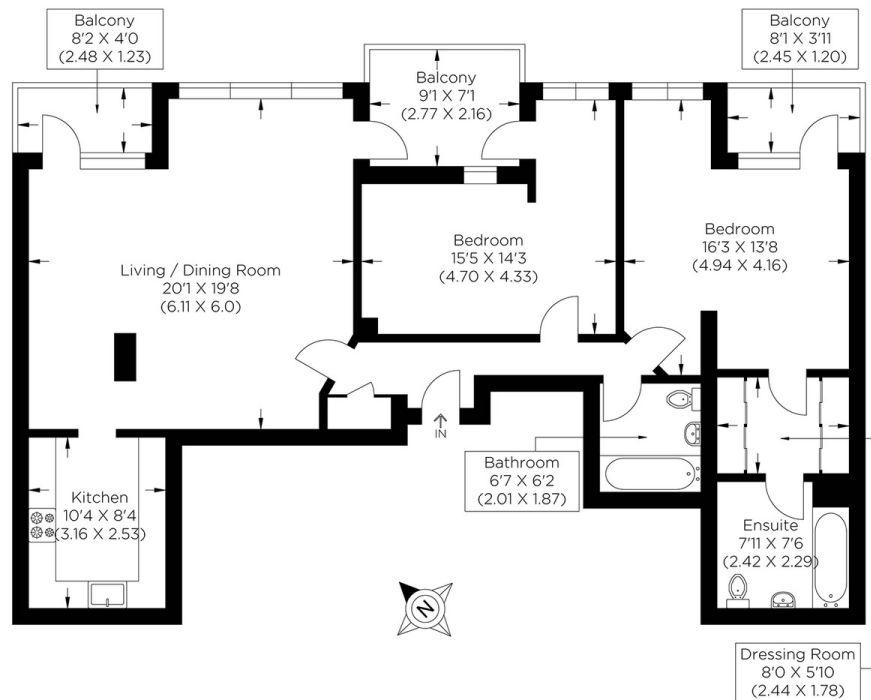

Sixth Floor

Approximate gross internal area  
 96.80 sq m / 1041.94 sq ft



**Canary Wharf & Docklands Office**  
 2 Westferry Road, Canary Wharf, London E14 8JT

t: 020 7537 9859 e: [canarywharf@alexneil.com](mailto:canarywharf@alexneil.com)

Disclaimer: Property descriptions are subjective and used in good faith as an opinion rather than statements of fact. The owner provided information relating to title, tenure, service charges and ground rent information. Therefore, please make specific enquiries to ensure that our descriptions match your expectations of the property. Floor plan measurements are approximate and for illustrative purposes only. Furthermore, we have not tested any services, systems or appliances at this property. And we strongly recommend that you verify all the provided information on inspection and that your surveyor and conveyancer further confirm details. Also, market conditions and property values regularly fluctuate. And showcased sold properties demonstrate our previous successes rather than indicate live property values. \*As advised by the owner. \*\*Property sold subject to contract.

# ALEX NEIL

ESTATE AGENTS SINCE 1984

2024 signifies our **40th Anniversary**, and we are immensely proud to have reached this impressive longevity milestone. In celebration, we launched an **exceptional promotion** for sellers, affording them increased marketing exposure for free!

**40 years of expertise:** With four decades of experience, we bring a wealth of knowledge and expertise. Our durability is a testament to the trust satisfied clients place in us. We understand the nuances of the diverse neighbourhoods we cover. Our local expertise allows us to provide tailored solutions, whether you're buying or selling, allowing you to move with confidence.



ALEX NEIL

ESTATE AGENTS SINCE 1984

[www.alexneil.com](http://www.alexneil.com)