



IVY POINT E3
2 bedroom apartment

£475,000
LEASEHOLD



IVY POINT E3

Forming part of this widely revered development is a two-bedroom, two-bathroom apartment situated within Ivy Point, Hannaford Walk, Bow E3. The apartment boasts a bright, airy, and impressively spacious dual-aspect living area with a separate top-specification fitted kitchen/diner and a complete range of high-end kitchen appliances. The property features a welcoming and spacious reception hallway with a large built-in storage cupboard and a sizeable private balcony directly accessed via the living area. It is perfect for al-fresco dining, entertaining guests, or relaxing with a good book on a sunny afternoon! Additional benefits include an extra-large bathroom and an en-suite shower room to the main bedroom. Ivy Point stands within just a few metres of Bromley-By-Bow Tube Station (District & Hammersmith & City). The residents of the building benefit from a concierge, residents roof terrace and a gym.

Borough: Tower Hamlets* Council Tax: D* EPC: B Lease Term: 150 years* Service Charge: £3,931* Ground Rent: £325*
Nearest Station: Bromley-by-Bow (0.14 miles) Material Information: www.alexneil.com/material-information

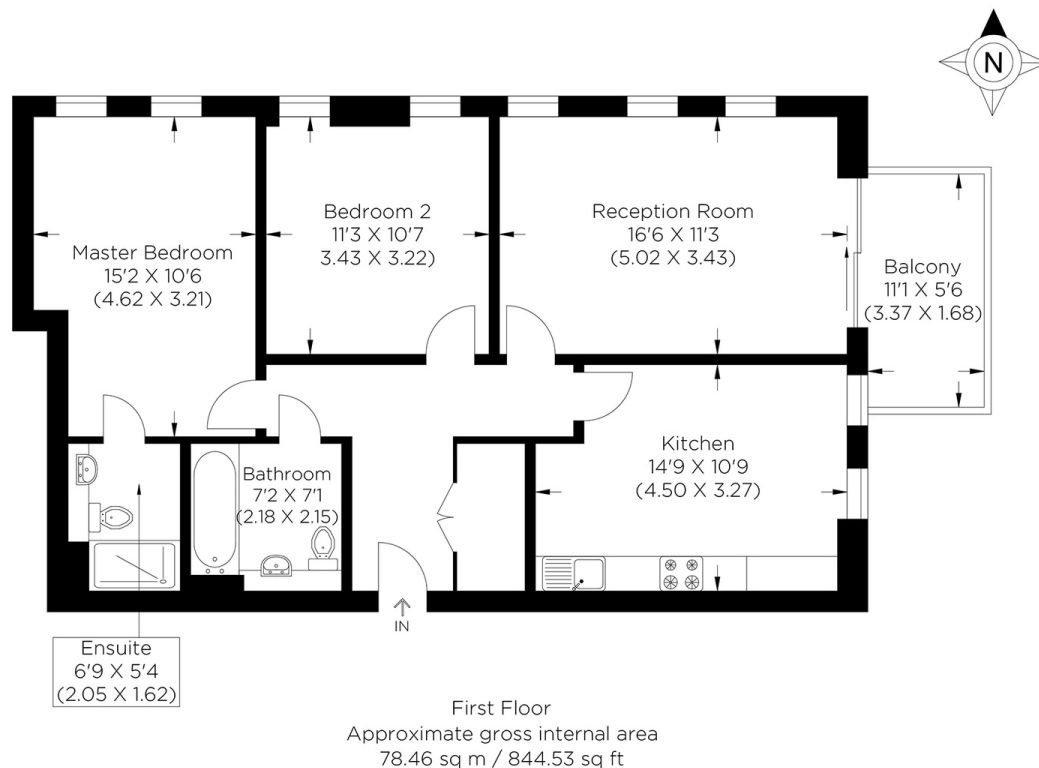

Canary Wharf & Docklands Office
2 Westferry Road, Canary Wharf, London E14 8JT

t: 020 7537 9859 e: canarywharf@alexneil.com

Disclaimer: Property descriptions are subjective and used in good faith as an opinion rather than statements of fact. The owner provided information relating to title, tenure, service charges and ground rent information. Therefore, please make specific enquiries to ensure that our descriptions match your expectations of the property. Floor plan measurements are approximate and for illustrative purposes only. Furthermore, we have not tested any services, systems or appliances at this property. And we strongly recommend that you verify all the provided information on inspection and that your surveyor and conveyancer further confirm details. Also, market conditions and property values regularly fluctuate. And showcased sold properties demonstrate our previous successes rather than indicate live property values. *As advised by the owner. **Property sold subject to contract.

ALEX NEIL

ESTATE AGENTS SINCE 1984

2024 signifies our **40th Anniversary**, and we are immensely proud to have reached this impressive longevity milestone. In celebration, we launched an **exceptional promotion** for sellers, affording them increased marketing exposure for free!

40 years of expertise: With four decades of experience, we bring a wealth of knowledge and expertise. Our durability is a testament to the trust satisfied clients place in us. We understand the nuances of the diverse neighbourhoods we cover. Our local expertise allows us to provide tailored solutions, whether you're buying or selling, allowing you to move with confidence.



ALEX NEIL

ESTATE AGENTS SINCE 1984

www.alexneil.com