



KITSON HOUSE E3  
**1 bedroom apartment**

**£375,000**  
SOLD STC\*\*





# KITSON HOUSE E3

This immaculate apartment in Kitson House, Corsican Square, Bow, E3, is spacious throughout. You'll witness the apartment's superb presentation and generous proportions immediately. The generosity of the layout is evident with a large bedroom with storage and a separate family bathroom. Towards the end of the hallway, you have the sizeable open-plan style living/dining/kitchen area. With floor-to-ceiling windows, you'll always have natural light. In addition, the room provides access to the balcony so you can enjoy the outside space whilst unwinding from a long day. Lime Quarter has a real sense of community with many independent shops and cafes nearby. Kitson House is also within a stone's throw of Devon's Road DLR, and Bromley by Bow Underground is slightly further, making commuting to Canary Wharf and the City a breeze.

Borough: Tower Hamlets\* Council Tax: C\* EPC: B Lease Term: 245 years\* Service Charge: £2,700\* Ground Rent: £350\*  
Nearest Station: Devons Road (0.04 miles) Material Information: [www.alexneil.com/material-information](http://www.alexneil.com/material-information)

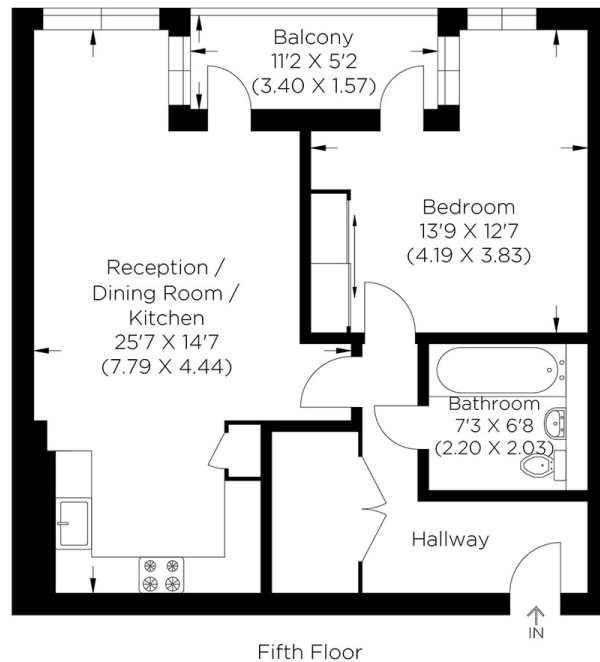

Approximate gross internal area  
53.84 sq m / 579.52 sq ft



**Canary Wharf & Docklands Office**  
2 Westferry Road, Canary Wharf, London E14 8JT

t: 020 7537 9859 e: [canarywharf@alexneil.com](mailto:canarywharf@alexneil.com)

Disclaimer: Property descriptions are subjective and used in good faith as an opinion rather than statements of fact. The owner provided information relating to title, tenure, service charges and ground rent information. Therefore, please make specific enquiries to ensure that our descriptions match your expectations of the property. Floor plan measurements are approximate and for illustrative purposes only. Furthermore, we have not tested any services, systems or appliances at this property. And we strongly recommend that you verify all the provided information on inspection and that your surveyor and conveyancer further confirm details. Also, market conditions and property values regularly fluctuate. And showcased sold properties demonstrate our previous successes rather than indicate live property values. \*As advised by the owner. \*\*Property sold subject to contract.

## ALEX NEIL

ESTATE AGENTS SINCE 1984

2024 signifies our **40th Anniversary**, and we are immensely proud to have reached this impressive longevity milestone. In celebration, we launched an **exceptional promotion** for sellers, affording them increased marketing exposure for free!

**40 years of expertise:** With four decades of experience, we bring a wealth of knowledge and expertise. Our durability is a testament to the trust satisfied clients place in us. We understand the nuances of the diverse neighbourhoods we cover. Our local expertise allows us to provide tailored solutions, whether you're buying or selling, allowing you to move with confidence.



ALEX NEIL

ESTATE AGENTS SINCE 1984

[www.alexneil.com](http://www.alexneil.com)