



SHEPPARD DRIVE SE16
2 bedroom apartment

£325,000
LEASEHOLD



SHEPPARD DRIVE SE16

This two-bedroom apartment is on the established and sought-after Sheppard Drive, South Bermondsey SE16. This spacious ground-floor property is presented in good condition throughout and internally comprises an airy reception room, a fully fitted kitchen with integrated appliances, a large double bedroom, a single bedroom and a three-piece family bathroom. Additionally, there is residents' parking and well-tended gardens. Sheppard Drive is a peaceful residential area between Rotherhithe and Bermondsey. Excellent central London links are available from the nearby South Bermondsey train station. Surrey Quays station and Shopping Centre are under a mile from Rossetti Road. We highly recommend booking your appointment to view this apartment.

Borough: Southwark* Council Tax: C* EPC: C Lease Term: 96 years* Service Charge: £1,740* Ground Rent: £150*
Nearest Station: South Bermondsey (0.32 miles) Material Information: www.alexneil.com/material-information

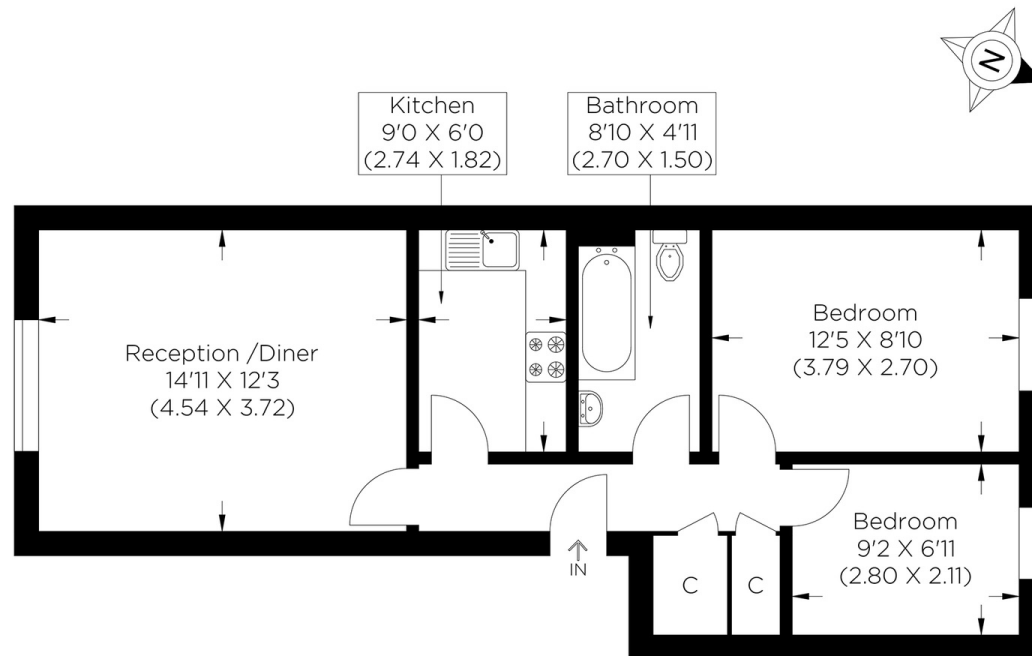

Approximate gross internal area
50.79 sq m / 546.69 sq ft

Rotherhithe & Bermondsey Office
146 Lower Road, London SE16 2UG

t: 020 7237 6767 e: rotherhithe@alexneil.com

Disclaimer: Property descriptions are subjective and used in good faith as an opinion rather than statements of fact. The owner provided information relating to title, tenure, service charges and ground rent information. Therefore, please make specific enquiries to ensure that our descriptions match your expectations of the property. Floor plan measurements are approximate and for illustrative purposes only. Furthermore, we have not tested any services, systems or appliances at this property. And we strongly recommend that you verify all the provided information on inspection and that your surveyor and conveyancer further confirm details. Also, market conditions and property values regularly fluctuate. And showcased sold properties demonstrate our previous successes rather than indicate live property values. *As advised by the owner. **Property sold subject to contract.



ALEX NEIL

ESTATE AGENTS SINCE 1984

2024 signifies our **40th Anniversary**, and we are immensely proud to have reached this impressive longevity milestone. In celebration, we launched an **exceptional promotion** for sellers, affording them increased marketing exposure for free!

40 years of expertise: With four decades of experience, we bring a wealth of knowledge and expertise. Our durability is a testament to the trust satisfied clients place in us. We understand the nuances of the diverse neighbourhoods we cover. Our local expertise allows us to provide tailored solutions, whether you're buying or selling, allowing you to move with confidence.



ALEX NEIL

ESTATE AGENTS SINCE 1984

www.alexneil.com