



COOMBE HOUSE E3  
**3 bedroom apartment**

**£550,000**  
SOLD STC\*\*





# COOMBE HOUSE E3

Situated on the fourth floor of Coombe House on Knapp Road, Bow E3, this impeccable three-bedroom apartment exudes sophistication. Each room is adorned with contemporary decor, suffused with an abundance of natural light that gracefully permeates every corner. The apartment encompasses three bedrooms and two bathrooms, one of which is a luxurious en-suite. Moreover, it showcases a spacious open-plan reception room, a sleek modern kitchen, and an expansive balcony, offering panoramic vistas of Canary Wharf, the City, and beyond. Nestled in an enviable location, mere moments from the enchanting Mile End Park, this property ensures convenience and tranquillity. Seamless commuting is guaranteed, with the nearest underground station at Bow Road mere minutes away. Furthermore, this property is free from any chain, underscoring its desirability. We emphatically urge you to arrange an early viewing to fully appreciate the splendour and elegance that this residence affords.

Borough: Tower Hamlets\* Council Tax: E\* EPC: B Lease Term: 248 years\* Service Charge: £2,058\* Ground Rent: £250\*  
Nearest Station: Devons Road (0.17 miles) Material Information: [www.alexneil.com/material-information](http://www.alexneil.com/material-information)

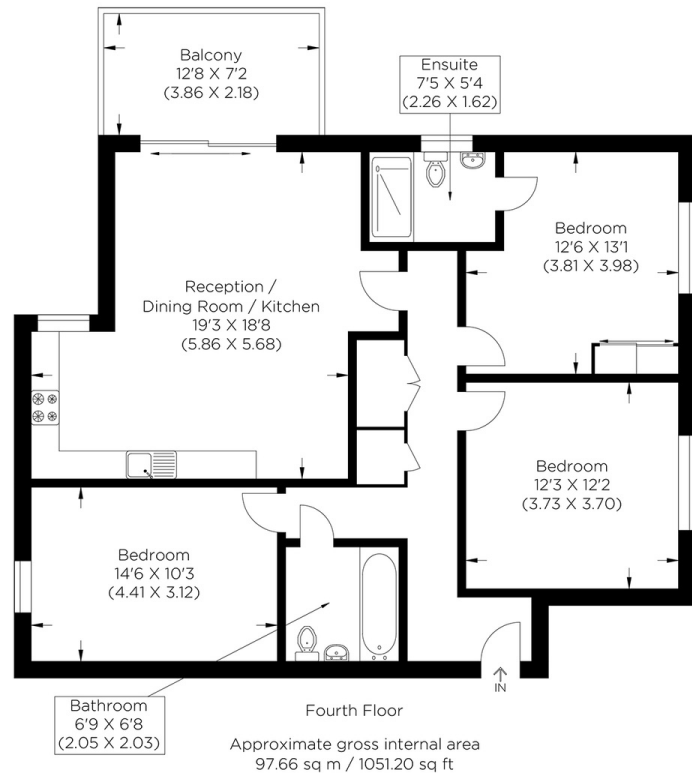

**Canary Wharf & Docklands Office**  
2 Westferry Road, Canary Wharf, London E14 8JT

t: 020 7537 9859 e: [canarywharf@alexneil.com](mailto:canarywharf@alexneil.com)

Disclaimer: Property descriptions are subjective and used in good faith as an opinion rather than statements of fact. The owner provided information relating to title, tenure, service charges and ground rent information. Therefore, please make specific enquiries to ensure that our descriptions match your expectations of the property. Floor plan measurements are approximate and for illustrative purposes only. Furthermore, we have not tested any services, systems or appliances at this property. And we strongly recommend that you verify all the provided information on inspection and that your surveyor and conveyancer further confirm details. Also, market conditions and property values regularly fluctuate. And showcased sold properties demonstrate our previous successes rather than indicate live property values. \*As advised by the owner. \*\*Property sold subject to contract.

# ALEX NEIL

ESTATE AGENTS SINCE 1984

2024 signifies our **40th Anniversary**, and we are immensely proud to have reached this impressive longevity milestone. In celebration, we launched an **exceptional promotion** for sellers, affording them increased marketing exposure for free!

**40 years of expertise:** With four decades of experience, we bring a wealth of knowledge and expertise. Our durability is a testament to the trust satisfied clients place in us. We understand the nuances of the diverse neighbourhoods we cover. Our local expertise allows us to provide tailored solutions, whether you're buying or selling, allowing you to move with confidence.



ALEX NEIL

ESTATE AGENTS SINCE 1984

[www.alexneil.com](http://www.alexneil.com)