



P Resident permit holders only
C
Mon - Sat
9 am - 5 pm
Sunday
9 am - 6 pm

PRIOR STREET SE10
3 bedroom town house

£800,000
SOLD



PRIOR STREET SE10

This Victorian townhouse set in the characterful Prior Street, Greenwich SE10, is rare to the market and chain-free. This sought-after road is perfect for the Cutty Sark DLR. Prior Street is an excellent canvas for someone looking for a character-rich property that would benefit from various modifications and extensions subject to planning permission and building regulations. Internally, the property offers abundant space, enhanced by the high ceilings, large sash windows, and direct access to the large private garden. Prior Street is in the centre of a friendly, community-focused area that enjoys many independent retailers, coffee spots, and fabulous gastro pubs. Set within easy reach of the prestigious Blackheath Village, historic Greenwich, and the glorious green space of Greenwich Park, this wonderful home affords fine dining options and picturesque settings to enjoy. We highly recommend booking your viewing appointment.

Borough: Royal Greenwich* Council Tax: F* EPC: D

Nearest Station: Greenwich (0.16 miles) Material Information: www.alexneil.com/material-information

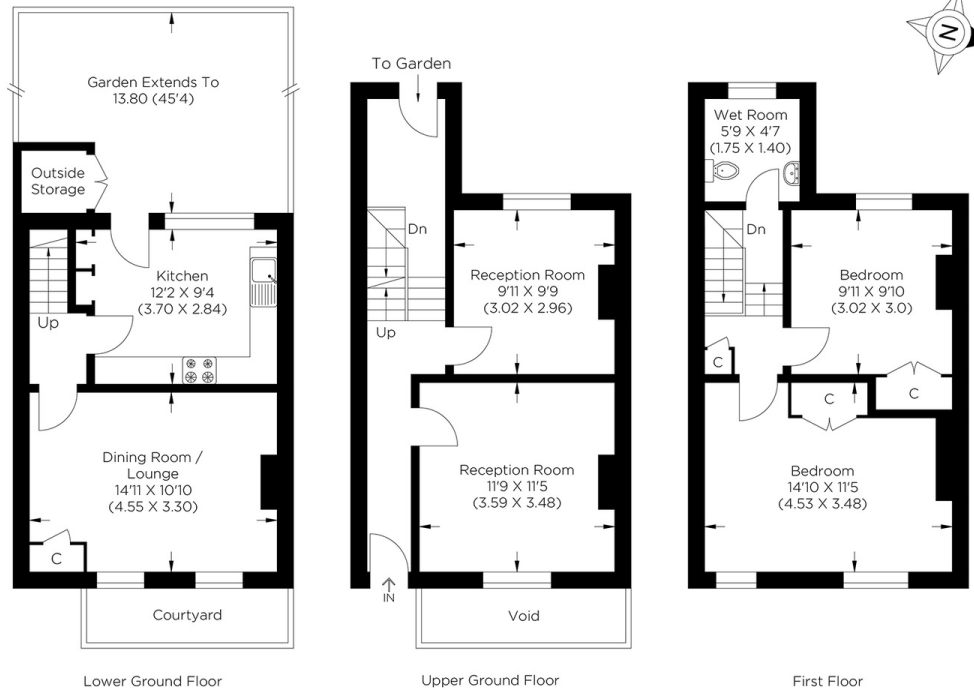

Approximate gross internal area 95.64 sq m / 1029.46 sq ft (Excluding Storage)



Rotherhithe & Bermondsey Office
146 Lower Road, London SE16 2UG

t: 020 7237 6767 e: rotherhithe@alexneil.com

Disclaimer: Property descriptions are subjective and used in good faith as an opinion rather than statements of fact. The owner provided information relating to title, tenure, service charges and ground rent information. Therefore, please make specific enquiries to ensure that our descriptions match your expectations of the property. Floor plan measurements are approximate and for illustrative purposes only. Furthermore, we have not tested any services, systems or appliances at this property. And we strongly recommend that you verify all the provided information on inspection and that your surveyor and conveyancer further confirm details. Also, market conditions and property values regularly fluctuate. And showcased sold properties demonstrate our previous successes rather than indicate live property values. *As advised by the owner. **Property sold subject to contract.

ALEX NEIL

ESTATE AGENTS SINCE 1984

2024 signifies our **40th Anniversary**, and we are immensely proud to have reached this impressive longevity milestone. In celebration, we launched an **exceptional promotion** for sellers, affording them increased marketing exposure for free!

40 years of expertise: With four decades of experience, we bring a wealth of knowledge and expertise. Our durability is a testament to the trust satisfied clients place in us. We understand the nuances of the diverse neighbourhoods we cover. Our local expertise allows us to provide tailored solutions, whether you're buying or selling, allowing you to move with confidence.



ALEX NEIL

ESTATE AGENTS SINCE 1984

www.alexneil.com