



RICHARD HOUSE DRIVE E16
3 bedroom end of terrace

£440,000
SOLD



RICHARD HOUSE DRIVE E16

Tranquilly located close to woodlands, parks and the historic water spaces of the Royal Docks, we present an exquisite three-bedroom end-of-terrace home on Richard House Drive, Beckton E16. The house comprises a lovely bright, airy living room, a large kitchen with ample storage, three generous size bedrooms, a family bathroom and access to the loft. The garden offers a delightful outdoor area perfect for the summer months. The property's convenient location is in a quiet cul-de-sac with private parking. It offers fabulous transport links with Royal Albert, Prince Regent and Custom House DLR (Cross Rail) stations within easy reach. The property is adjacent to the vibrant and evolving Royal Docks, with water sports, restaurants and bars within easy walking distance. We highly recommend an internal viewing to fully appreciate the accommodation and the house benefits from being sold chain free.

Borough: Newham* Council Tax: D* EPC: C

Nearest Station: Royal Albert (0.15 miles) Material Information: www.alexneil.com/material-information

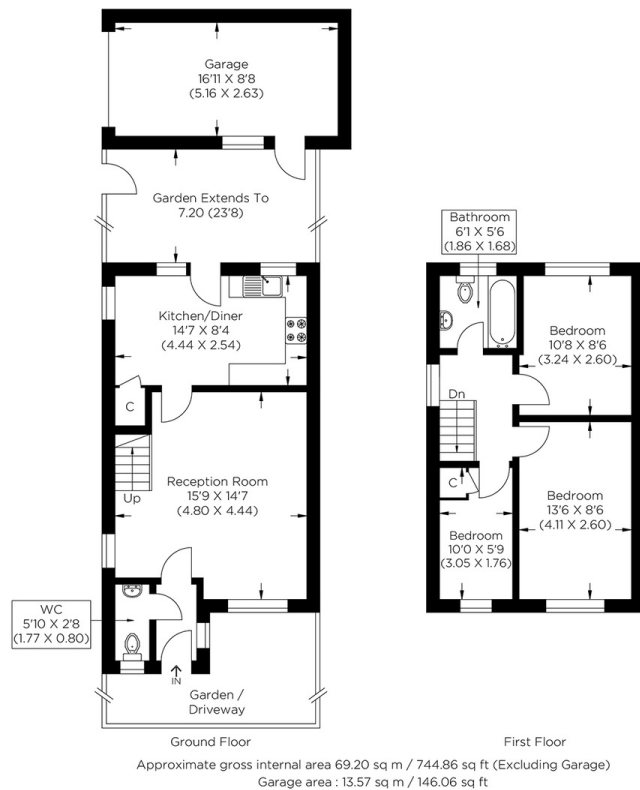

Canary Wharf & Docklands Office
2 Westferry Road, Canary Wharf, London E14 8JT

t: 020 7537 9859 e: canarywharf@alexneil.com

Disclaimer: Property descriptions are subjective and used in good faith as an opinion rather than statements of fact. The owner provided information relating to title, tenure, service charges and ground rent information. Therefore, please make specific enquiries to ensure that our descriptions match your expectations of the property. Floor plan measurements are approximate and for illustrative purposes only. Furthermore, we have not tested any services, systems or appliances at this property. And we strongly recommend that you verify all the provided information on inspection and that your surveyor and conveyancer further confirm details. Also, market conditions and property values regularly fluctuate. And showcased sold properties demonstrate our previous successes rather than indicate live property values. *As advised by the owner. **Property sold subject to contract.

ALEX NEIL

ESTATE AGENTS SINCE 1984

2024 signifies our **40th Anniversary**, and we are immensely proud to have reached this impressive longevity milestone. In celebration, we launched an **exceptional promotion** for sellers, affording them increased marketing exposure for free!

40 years of expertise: With four decades of experience, we bring a wealth of knowledge and expertise. Our durability is a testament to the trust satisfied clients place in us. We understand the nuances of the diverse neighbourhoods we cover. Our local expertise allows us to provide tailored solutions, whether you're buying or selling, allowing you to move with confidence.



ALEX NEIL

ESTATE AGENTS SINCE 1984

www.alexneil.com