



CHANCELLOR HOUSE SE16
2 bedroom apartment

£500,000
SOLD



CHANCELLOR HOUSE SE16

This stylish two-double-bedroom apartment is on the fifteenth floor of the modern Chancellor House, forming part of the prestigious Bermondsey Works SE16 development. This neutrally decorated property internally comprises an ample open plan kitchen/living room with direct access to a large private balcony offering unparalleled views of the City, two spacious double bedrooms, an en-suite to the master and a stylish three-piece family bathroom. The property also benefits from a 24-hour concierge, a large new landscaped roof terrace, a gymnasium and ample storage. Chancellor House enjoys easy access to excellent transport links into the City and Central London. The apartment also boasts underfloor heating, ultrafast broadband and an allocated parking space available upon negotiation. This wonderful apartment offers the utmost convenience. We recommend organising your appointment to view it.

Borough: Southwark* Council Tax: D* EPC: B Lease Term: 993 years* Service Charge: £3,300* Ground Rent: £450*
Nearest Station: South Bermondsey (0.43 miles) Material Information: www.alexneil.com/material-information

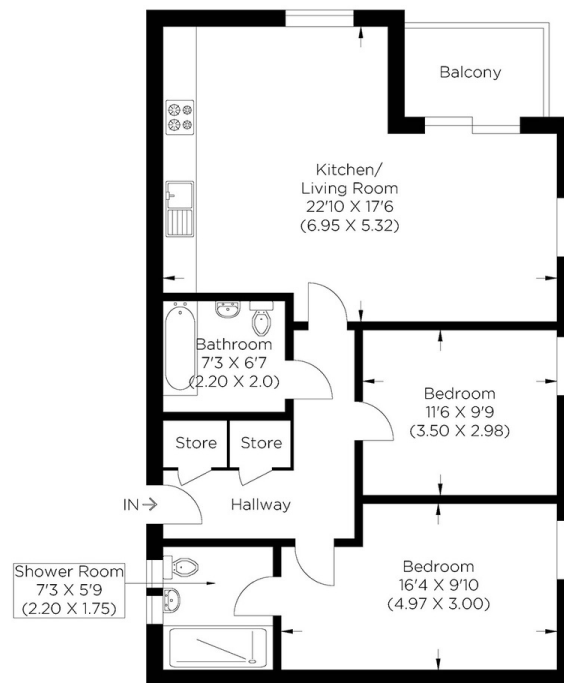

Approximate gross internal area
76.47 sq m / 823.11 sq ft

Rotherhithe & Bermondsey Office
146 Lower Road, London SE16 2UG

t: 020 7237 6767 e: rotherhithe@alexneil.com

Disclaimer: Property descriptions are subjective and used in good faith as an opinion rather than statements of fact. The owner provided information relating to title, tenure, service charges and ground rent information. Therefore, please make specific enquiries to ensure that our descriptions match your expectations of the property. Floor plan measurements are approximate and for illustrative purposes only. Furthermore, we have not tested any services, systems or appliances at this property. And we strongly recommend that you verify all the provided information on inspection and that your surveyor and conveyancer further confirm details. Also, market conditions and property values regularly fluctuate. And showcased sold properties demonstrate our previous successes rather than indicate live property values. *As advised by the owner. **Property sold subject to contract.



ALEX NEIL

ESTATE AGENTS SINCE 1984

2024 signifies our **40th Anniversary**, and we are immensely proud to have reached this impressive longevity milestone. In celebration, we launched an **exceptional promotion** for sellers, affording them increased marketing exposure for free!

40 years of expertise: With four decades of experience, we bring a wealth of knowledge and expertise. Our durability is a testament to the trust satisfied clients place in us. We understand the nuances of the diverse neighbourhoods we cover. Our local expertise allows us to provide tailored solutions, whether you're buying or selling, allowing you to move with confidence.



ALEX NEIL

ESTATE AGENTS SINCE 1984

www.alexneil.com