



GRAY COURT E1
1 bedroom apartment

£325,000
SOLD



GRAY COURT E1

We present a spacious one-bedroom apartment with direct canal views in good condition in Gray Court, Candle Street, Stepney Green E1 4RT. This home's floor plan is particularly generous in size and is perfect for first-time buyers and buy-to-let investors alike. The bedroom, for example, has built-in wardrobes, a double bed, side tables and even space for a large desk. The home also has an open-plan style kitchen/dining/living room with a wealth of natural light flooding through the Juliette balcony overlooking the canal. You will lose yourself on the sofa just watching the ducks go by. Gray Court's convenient location is between Stepney Green and Mile End underground train stations allowing an easy commute throughout London. Staying local, you have an abundance of amenities right on your doorstep, ranging from a pharmacy to local grocery shops, restaurants and much more!

Borough: Tower Hamlets* Council Tax: C* EPC: B Lease Term: 110 years* Service Charge: £2,232* Ground Rent: £150*
Nearest Station: Limehouse (0.43 miles) Material Information: www.alexneil.com/material-information

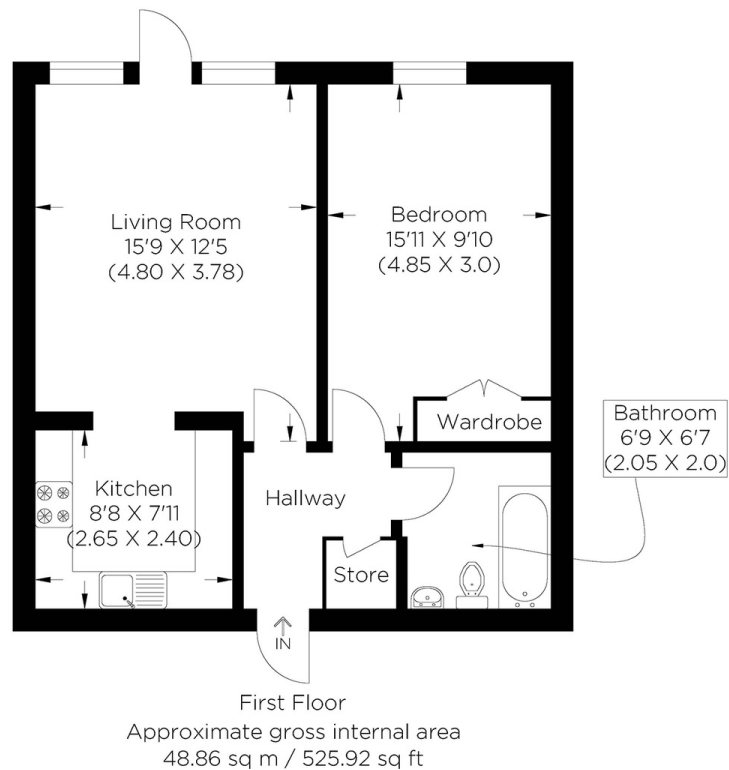

Canary Wharf & Docklands Office
2 Westferry Road, Canary Wharf, London E14 8JT

t: 020 7537 9859 e: canarywharf@alexneil.com

Disclaimer: Property descriptions are subjective and used in good faith as an opinion rather than statements of fact. The owner provided information relating to title, tenure, service charges and ground rent information. Therefore, please make specific enquiries to ensure that our descriptions match your expectations of the property. Floor plan measurements are approximate and for illustrative purposes only. Furthermore, we have not tested any services, systems or appliances at this property. And we strongly recommend that you verify all the provided information on inspection and that your surveyor and conveyancer further confirm details. Also, market conditions and property values regularly fluctuate. And showcased sold properties demonstrate our previous successes rather than indicate live property values. *As advised by the owner. **Property sold subject to contract.

ALEX NEIL

ESTATE AGENTS SINCE 1984

2024 signifies our **40th Anniversary**, and we are immensely proud to have reached this impressive longevity milestone. In celebration, we launched an **exceptional promotion** for sellers, affording them increased marketing exposure for free!

40 years of expertise: With four decades of experience, we bring a wealth of knowledge and expertise. Our durability is a testament to the trust satisfied clients place in us. We understand the nuances of the diverse neighbourhoods we cover. Our local expertise allows us to provide tailored solutions, whether you're buying or selling, allowing you to move with confidence.



ALEX NEIL

ESTATE AGENTS SINCE 1984

www.alexneil.com