



MATCHSTICK APARTMENTS E3  
**2 bedroom apartment**

**£500,000**  
SOLD





# MATCHSTICK APARTMENTS E3

We present a wonderfully sized two double-bedroom apartment in superb condition in Matchstick Apartments, Fairfield Road, Bow E3. For those looking for size, look no further! As soon as you walk through the front door, the substantial and welcoming large hallway is perfect for storage options. To the right, you have both the double bedrooms, very generous in size and en-suite to the master. To the other side of the property, you have the vast open-plan style kitchen/dining/living room with direct access to the private balcony. In addition, you also have the family bathroom and further storage cupboards. The location of this home is equally special. Whether you are looking to commute, go to the shops or take advantage of the wealth of local amenities, you are just a short walk away. Bow Church DLR and Bow Road Underground are all within easy walking distance, making any commute to Stratford, Canary Wharf and the City quick and easy.

Borough: Tower Hamlets\* Council Tax: D\* EPC: B Lease Term: 145\* Service Charge: £2,400\* Ground Rent: £450\*

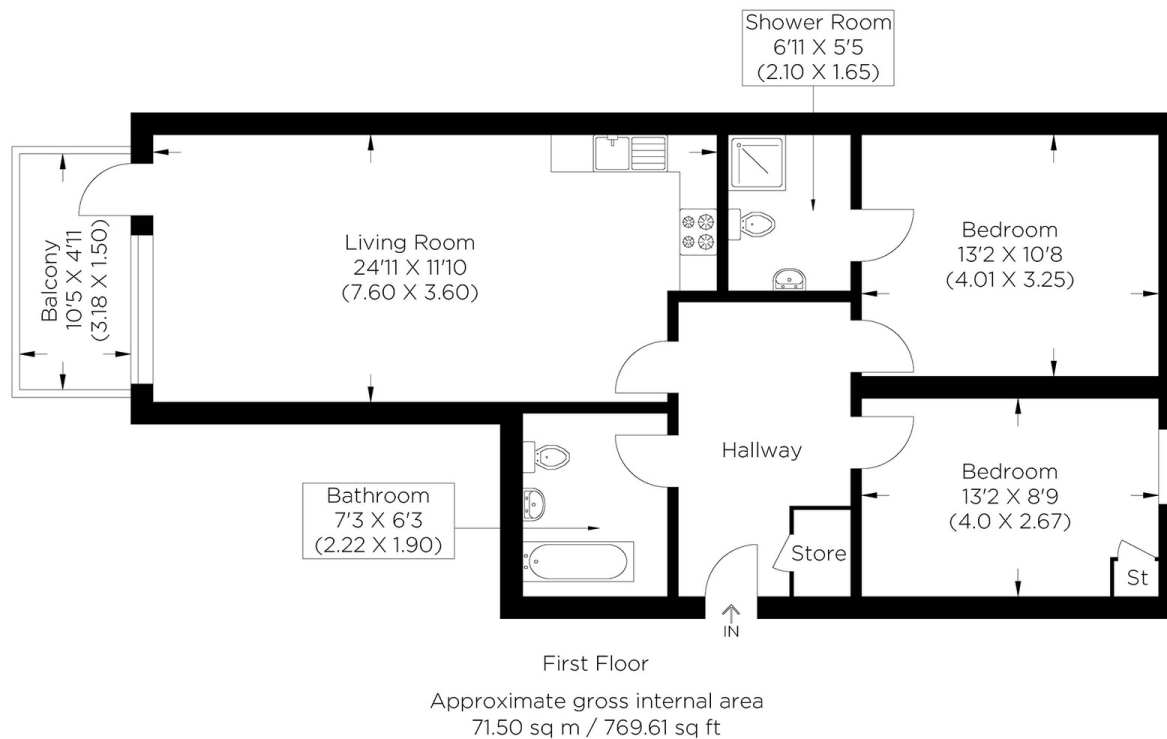

**Canary Wharf & Docklands Office**  
**2 Westferry Road, Canary Wharf, London E14 8JT**

t: 020 7537 9859 e: [canarywharf@alexneil.com](mailto:canarywharf@alexneil.com)

Disclaimer: Property descriptions are subjective and used in good faith as an opinion rather than statements of fact. The owner provided information relating to title, tenure, service charges and ground rent information. Therefore, please make specific enquiries to ensure that our descriptions match your expectations of the property. Floor plan measurements are approximate and for illustrative purposes only. Furthermore, we have not tested any services, systems or appliances at this property. And we strongly recommend that you verify all the provided information on inspection and that your surveyor and conveyancer further confirm details. Also, market conditions and property values regularly fluctuate. And showcased sold properties demonstrate our previous successes rather than indicate live property values. \*As advised by the owner. \*\*Property sold subject to contract.



## ALEX NEIL

ESTATE AGENTS SINCE 1984