



VICTORIA HOUSE SE16  
**2 bedroom apartment**

**£635,000**  
SOLD





# VICTORIA HOUSE SE16

We present a stunning two-bedroom apartment in Victoria House, Surrey Quays Road, Canada Water, SE16. This exceptionally well-presented two double-bedroom two bathroom apartment in the highly sought-after Maple Quays development is a moment's walk from Canada Water Tube Station (Jubilee Line, Zone 2). With two restaurants, two supermarkets, a shopping centre and Canada Water tube station all within a 5-minute walk, this location is fabulous. Further benefits include 24hr concierge, a residents' gym, and an underground parking space. Maple Quays is a stone's throw from Canada Water station, which benefits from access to the Jubilee line (only one stop to Canary Wharf and two stops to London Bridge) and also the London Overground service (direct links to Highbury & Islington via Shoreditch High Street proximate to Liverpool Street). There is also a bus station with numerous links both day and night. Victoria House is ideal for easy access to all of London.

Borough: Southwark\* Council Tax: D\* EPC: B Lease Term: 115 years\* Service Charge: £3,200\* Ground Rent: £448\*

Nearest Station: Canada Water (0.05 miles) Material Information: [www.alexneil.com/material-information](http://www.alexneil.com/material-information)

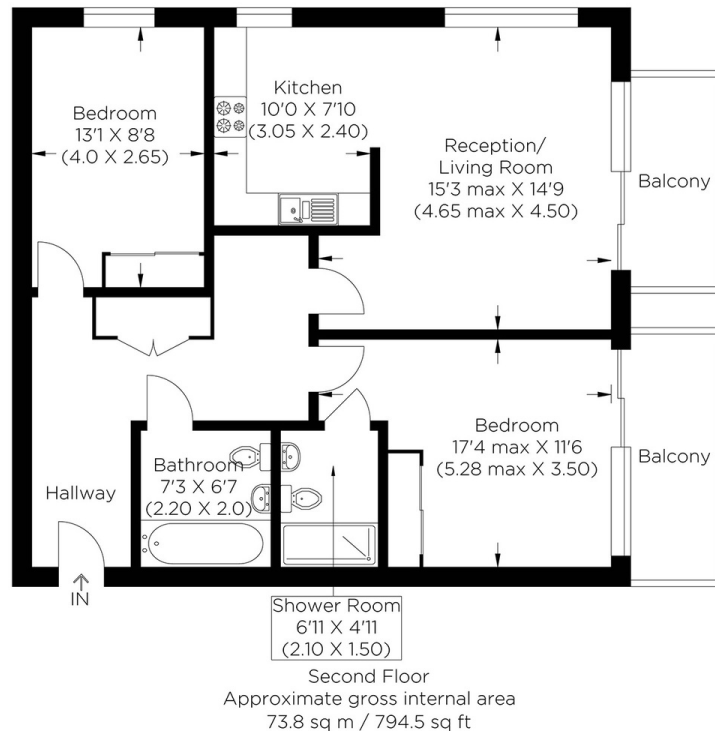

**Rotherhithe & Bermondsey Office**  
146 Lower Road, London SE16 2UG

t: 020 7237 6767 e: [rotherhithe@alexneil.com](mailto:rotherhithe@alexneil.com)

Disclaimer: Property descriptions are subjective and used in good faith as an opinion rather than statements of fact. The owner provided information relating to title, tenure, service charges and ground rent information. Therefore, please make specific enquiries to ensure that our descriptions match your expectations of the property. Floor plan measurements are approximate and for illustrative purposes only. Furthermore, we have not tested any services, systems or appliances at this property. And we strongly recommend that you verify all the provided information on inspection and that your surveyor and conveyancer further confirm details. Also, market conditions and property values regularly fluctuate. And showcased sold properties demonstrate our previous successes rather than indicate live property values. \*As advised by the owner. \*\*Property sold subject to contract.



## ALEX NEIL

ESTATE AGENTS SINCE 1984

2024 signifies our **40th Anniversary**, and we are immensely proud to have reached this impressive longevity milestone. In celebration, we launched an **exceptional promotion** for sellers, affording them increased marketing exposure for free!

**40 years of expertise:** With four decades of experience, we bring a wealth of knowledge and expertise. Our durability is a testament to the trust satisfied clients place in us. We understand the nuances of the diverse neighbourhoods we cover. Our local expertise allows us to provide tailored solutions, whether you're buying or selling, allowing you to move with confidence.



ALEX NEIL

ESTATE AGENTS SINCE 1984

[www.alexneil.com](http://www.alexneil.com)