



WIMHURST COURT E14
2 bedroom apartment

£525,000
SOLD



WIMHURST COURT E14

This outstanding two-bedroom top-floor apartment is in Wimhurst Court, Upper North Street, Poplar E14. This high-specification apartment offers abundant natural light, where the windows benefit from automated blinds. A good-sized living/dining room which has been decorated with 60's brick and has a semi-open plan kitchen providing access to a large balcony that can easily accommodate seating with views towards the canal. The master bedroom offers an en-suite bathroom and provides further access to the balcony. Elsewhere a spacious entrance hall offers excellent storage space and leads to a dual-aspect second bedroom. There is also a separate family bathroom. Set adjacent to Bartlett Park and perfect for commuters, Wimhurst Court is between Canary Wharf and the City via Westferry DLR station (0.4mi). In addition, tube links are available from Mile End (0.9mi) and Bromley-By-Bow (0.8mi). The current owners have tastefully designed the apartment, and it is chain-free.

Borough: Tower Hamlets* Council Tax: D* EPC: B Lease Term: 246* Service Charge: £2,000* Ground Rent: £460*

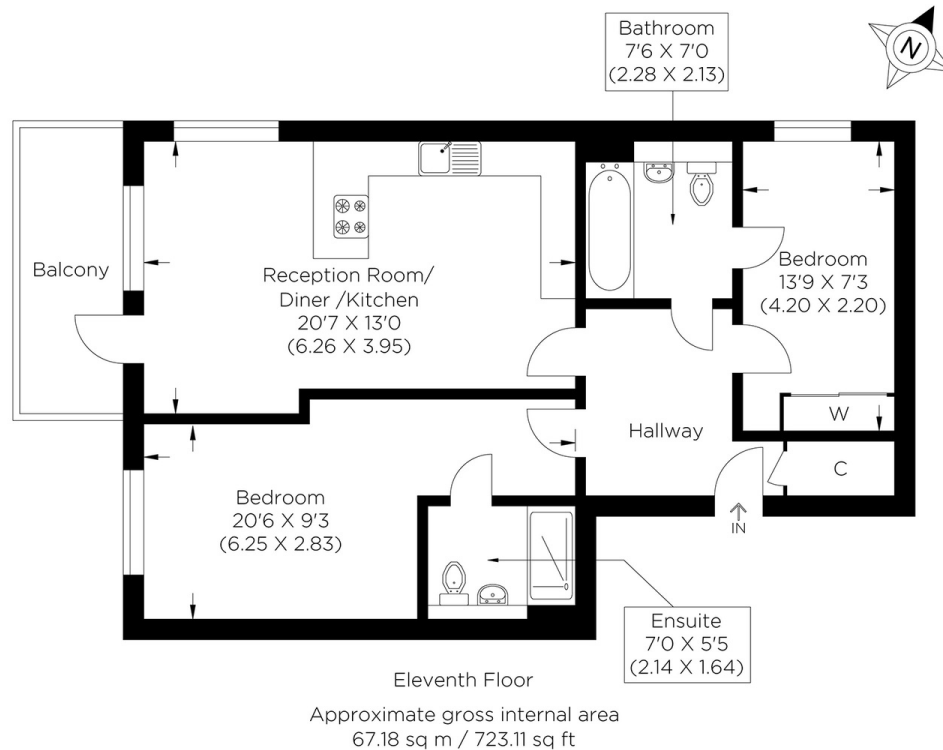

Canary Wharf & Docklands Office
2 Westferry Road, Canary Wharf, London E14 8JT

t: 020 7537 9859 e: canarywharf@alexneil.com

Disclaimer: Property descriptions are subjective and used in good faith as an opinion rather than statements of fact. The owner provided information relating to title, tenure, service charges and ground rent information. Therefore, please make specific enquiries to ensure that our descriptions match your expectations of the property. Floor plan measurements are approximate and for illustrative purposes only. Furthermore, we have not tested any services, systems or appliances at this property. And we strongly recommend that you verify all the provided information on inspection and that your surveyor and conveyancer further confirm details. Also, market conditions and property values regularly fluctuate. And showcased sold properties demonstrate our previous successes rather than indicate live property values. *As advised by the owner. **Property sold subject to contract.

ALEX NEIL

ESTATE AGENTS SINCE 1984