



FURZE LODGE SE18
1 bedroom apartment

£325,000
SOLD



FURZE LODGE SE18

A stunning one-bedroom flat is available in Furze Lodge, Plum Lane, Shooters Hill SE18. Furze Lodge forms part of an exclusive gated development with spectacular views towards Canary Wharf, the O2 Arena and the Royal Docks. Plum Lane is a tranquil place to live, surrounded by greenery. The property comprises an open plan kitchen lounge/dining area, one double bedroom, a luxurious bathroom, a wonderful private terrace off the living room, double glazed throughout, GCH and a secure parking space. The area is near parkland, a golf course and a tennis club, offering the opportunity to relax with the convenience of public transport just moments away. Plum Lane is easily accessible by road (A2/A20/South Circular) and public transport with various stations, including Woolwich Arsenal, Plumstead, and Falconwood. Local bus services connect to North Greenwich for the Jubilee Line at the O2 and the Elizabeth Line. We expect this home to sell quickly and recommend booking your earliest viewing.

Borough: Royal Greenwich* Council Tax: B* EPC: C Lease Term: 115* Service Charge: £1,892* Ground Rent: £279*

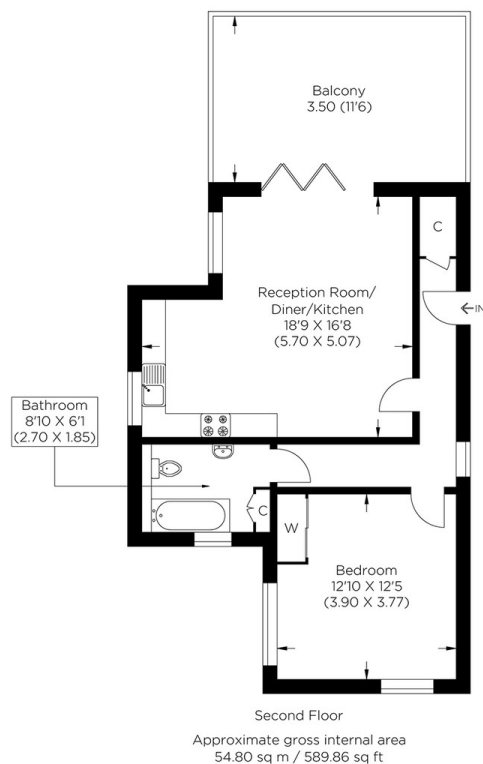

Rotherhithe & Bermondsey Office
146 Lower Road, London SE16 2UG

t: 020 7237 6767 e: rotherhithe@alexneil.com

Disclaimer: Property descriptions are subjective and used in good faith as an opinion rather than statements of fact. The owner provided information relating to title, tenure, service charges and ground rent information. Therefore, please make specific enquiries to ensure that our descriptions match your expectations of the property. Floor plan measurements are approximate and for illustrative purposes only. Furthermore, we have not tested any services, systems or appliances at this property. And we strongly recommend that you verify all the provided information on inspection and that your surveyor and conveyancer further confirm details. Also, market conditions and property values regularly fluctuate. And showcased sold properties demonstrate our previous successes rather than indicate live property values. *As advised by the owner. **Property sold subject to contract.

ALEX NEIL

ESTATE AGENTS SINCE 1984