



BROMLEY GROVE BR2
2 bedroom apartment

£375,000+
LEASEHOLD



BROMLEY GROVE BR2

We present this recently refurbished chain-free apartment set in the convenient Bromley Grove, Bromley BR2. The accommodation comprises a large separate lounge, a newly fitted kitchen with integrated appliances, two large bedrooms and a contemporary three-piece bathroom. This property also boasts high ceilings and a generous communal garden. The apartment's convenient Bromley Grove location is within easy reach of Shortlands railway station, offering fantastic transport links to Central London. In addition, the area provides various local amenities, including bars and pubs and walks in nearby Kelsey Park. This excellent apartment enjoys a superb location and will generate plenty of interest. We highly recommend organising your appointment to view this home.

Borough: Bromley* Council Tax: D* EPC: D Lease Term: 125 years* Service Charge: £3,362* Ground Rent: TBA
Nearest Station: Shortlands (0.32 miles) Material Information: www.alexneil.com/material-information

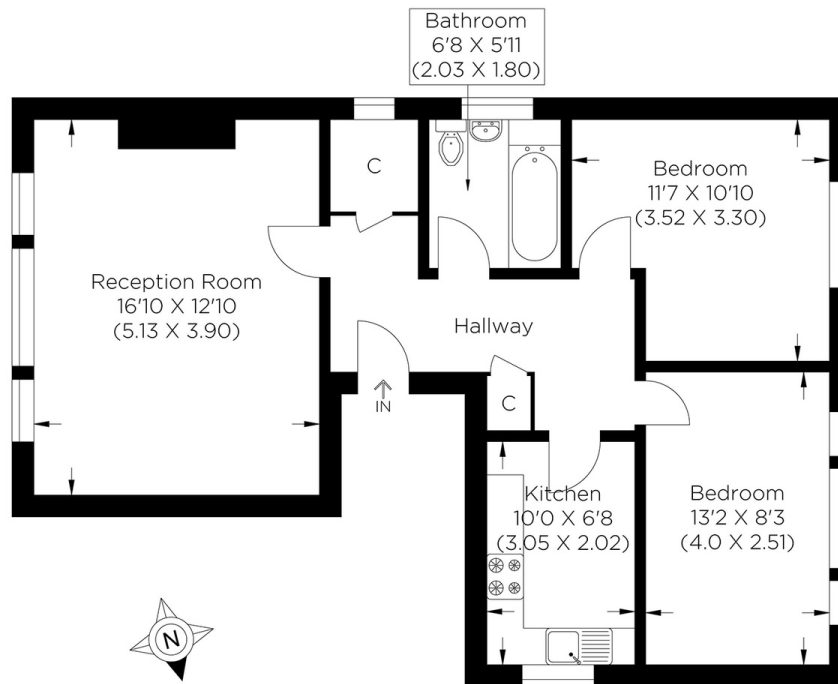

Approximate gross internal area
62.77 sq m / 675.65 sq ft

Rotherhithe & Bermondsey Office
146 Lower Road, London SE16 2UG

t: 020 7237 6767 e: rotherhithe@alexneil.com

Disclaimer: Property descriptions are subjective and used in good faith as an opinion rather than statements of fact. The owner provided information relating to title, tenure, service charges and ground rent information. Therefore, please make specific enquiries to ensure that our descriptions match your expectations of the property. Floor plan measurements are approximate and for illustrative purposes only. Furthermore, we have not tested any services, systems or appliances at this property. And we strongly recommend that you verify all the provided information on inspection and that your surveyor and conveyancer further confirm details. Also, market conditions and property values regularly fluctuate. And showcased sold properties demonstrate our previous successes rather than indicate live property values. *As advised by the owner. **Property sold subject to contract.



ALEX NEIL

ESTATE AGENTS SINCE 1984