



MILLENNIUM DRIVE E14
2 bedroom apartment

£525,000
SOLD



MILLENNIUM DRIVE E14

This spacious two-bedroom apartment is on the fifth floor of a modern purpose-built block, offering a waterside aspect overlooking the River Thames in Millennium Drive, Isle of Dogs, E14. The property spans just under one thousand square feet, benefiting from having generous room proportions with the added benefit of a secure allocated parking space and being sold chain free. The accommodation comprises a large reception room, a private balcony overlooking the river, a separate kitchen, a principal bedroom with a large en-suite and fitted wardrobe, a further double bedroom with a fitted wardrobe and a family bathroom. Millennium Drive is convenient for Island Gardens DLR, giving easy access to Canary Wharf, the Elizabeth and Jubilee Lines, the City and all the local amenities.

Borough: Tower Hamlets* Council Tax: F* EPC: C Lease Term: 95 years* Service Charge: £3,000* Ground Rent: £250*
Nearest Station: Island Gardens (0.44 miles) Material Information: www.alexneil.com/material-information

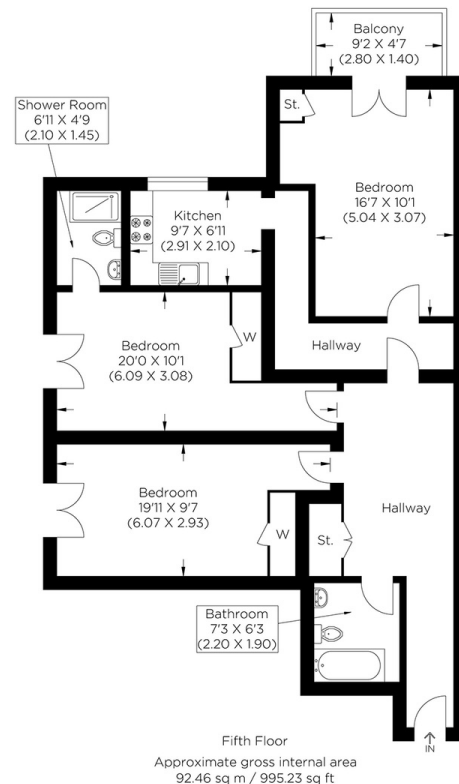

Canary Wharf & Docklands Office
2 Westferry Road, Canary Wharf, London E14 8JT

t: 020 7537 9859 e: canarywharf@alexneil.com

Disclaimer: Property descriptions are subjective and used in good faith as an opinion rather than statements of fact. The owner provided information relating to title, tenure, service charges and ground rent information. Therefore, please make specific enquiries to ensure that our descriptions match your expectations of the property. Floor plan measurements are approximate and for illustrative purposes only. Furthermore, we have not tested any services, systems or appliances at this property. And we strongly recommend that you verify all the provided information on inspection and that your surveyor and conveyancer further confirm details. Also, market conditions and property values regularly fluctuate. And showcased sold properties demonstrate our previous successes rather than indicate live property values. *As advised by the owner. **Property sold subject to contract.

ALEX NEIL

ESTATE AGENTS SINCE 1984

2024 signifies our **40th Anniversary**, and we are immensely proud to have reached this impressive longevity milestone. In celebration, we launched an **exceptional promotion** for sellers, affording them increased marketing exposure for free!

40 years of expertise: With four decades of experience, we bring a wealth of knowledge and expertise. Our durability is a testament to the trust satisfied clients place in us. We understand the nuances of the diverse neighbourhoods we cover. Our local expertise allows us to provide tailored solutions, whether you're buying or selling, allowing you to move with confidence.



ALEX NEIL

ESTATE AGENTS SINCE 1984

www.alexneil.com