



WHARFSIDE POINT SOUTH E14  
**1 bedroom apartment**

**£290,000**  
SOLD





# WHARFSIDE POINT SOUTH E14

We present for sale a beautiful ninth-floor apartment in Wharfside Point South, Prestons Road, Poplar E14. The accommodation comprises a spacious open-plan lounge with a high-specification integrated kitchen, a master bedroom, a stylish three-piece bathroom and abundant storage. In addition, Wharfside Point South has concierge services and a fabulous communal roof terrace. There are excellent rail links to Canary Wharf's retail, leisure and business plazas from nearby Blackwall DLR Station. We expect interest levels in this apartment to be high and advise booking your earliest viewing appointment.

Borough: Tower Hamlets\* Council Tax: C\* EPC: C Lease Term: 985 years\* Service Charge: £3,149\* Ground Rent: £250\*  
Nearest Station: Blackwall (0.09 miles) Material Information: [www.alexneil.com/material-information](http://www.alexneil.com/material-information)

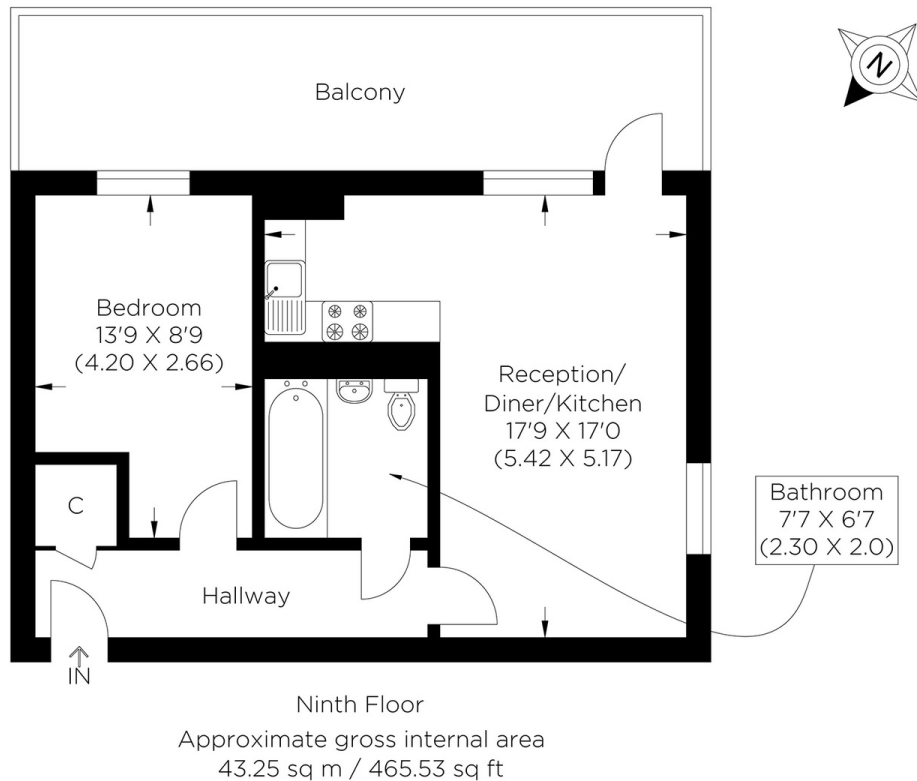

**Canary Wharf & Docklands Office**  
**2 Westferry Road, Canary Wharf, London E14 8JT**

**t: 020 7537 9859 e: [canarywharf@alexneil.com](mailto:canarywharf@alexneil.com)**

Disclaimer: Property descriptions are subjective and used in good faith as an opinion rather than statements of fact. The owner provided information relating to title, tenure, service charges and ground rent information. Therefore, please make specific enquiries to ensure that our descriptions match your expectations of the property. Floor plan measurements are approximate and for illustrative purposes only. Furthermore, we have not tested any services, systems or appliances at this property. And we strongly recommend that you verify all the provided information on inspection and that your surveyor and conveyancer further confirm details. Also, market conditions and property values regularly fluctuate. And showcased sold properties demonstrate our previous successes rather than indicate live property values. \*As advised by the owner. \*\*Property sold subject to contract.

## ALEX NEIL

ESTATE AGENTS SINCE 1984