



CITY VIEW HOUSE E2
2 bedroom apartment

£425,000
SOLD



CITY VIEW HOUSE E2

Within this beautiful conversion is this spacious two bedroom apartment in the desirable City View House, Bethnal Green Road, Bethnal Green E2. The apartment is set on the third floor of the famous, former Victorian biscuit factory set back from Bethnal Green Road. The apartment has been intelligently designed to maximise the space and its open-plan style creates a versatile set of rooms that flow naturally together, each flooded with natural light. The property comprises of a large open-plan kitchen/lounge, two double bedrooms and a modern family bathroom. This particular apartment comes with a parking space and the development itself benefits from a porter, secure bicycle storage and 24-hour security. The apartment is well connected via Bethnal Green Underground station, Cambridge Heath and Bethnal Green Overground stations.

Borough: Tower Hamlets* Council Tax: D* EPC: C Lease Term: 999 years* Service Charge: £4,078* Ground Rent: £230*
Nearest Station: Bethnal Green (0.09 miles) Material Information: www.alexneil.com/material-information

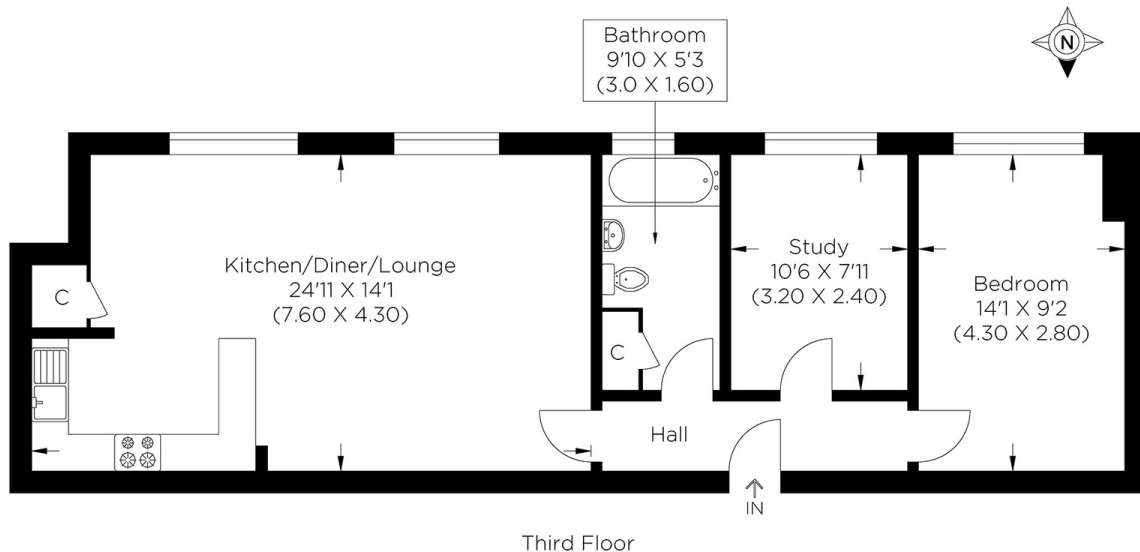

Approximate gross internal area
62.66 sq m / 674.46 sq ft



Canary Wharf & Docklands Office
2 Westferry Road, Canary Wharf, London E14 8JT

t: 020 7537 9859 e: canarywharf@alexneil.com

Disclaimer: Property descriptions are subjective and used in good faith as an opinion rather than statements of fact. The owner provided information relating to title, tenure, service charges and ground rent information. Therefore, please make specific enquiries to ensure that our descriptions match your expectations of the property. Floor plan measurements are approximate and for illustrative purposes only. Furthermore, we have not tested any services, systems or appliances at this property. And we strongly recommend that you verify all the provided information on inspection and that your surveyor and conveyancer further confirm details. Also, market conditions and property values regularly fluctuate. And showcased sold properties demonstrate our previous successes rather than indicate live property values. *As advised by the owner. **Property sold subject to contract.

ALEX NEIL

ESTATE AGENTS SINCE 1984

2024 signifies our **40th Anniversary**, and we are immensely proud to have reached this impressive longevity milestone. In celebration, we launched an **exceptional promotion** for sellers, affording them increased marketing exposure for free!

40 years of expertise: With four decades of experience, we bring a wealth of knowledge and expertise. Our durability is a testament to the trust satisfied clients place in us. We understand the nuances of the diverse neighbourhoods we cover. Our local expertise allows us to provide tailored solutions, whether you're buying or selling, allowing you to move with confidence.



ALEX NEIL

ESTATE AGENTS SINCE 1984

www.alexneil.com