



CAPSTAN WAY SE16  
**1 bedroom apartment**

**£315,000**  
SOLD





# CAPSTAN WAY SE16

This bright, airy one-bedroom apartment is in Capstan Way, Rotherhithe, SE16. Benefits include a spacious living/dining area, double bedroom, modern bathroom and a contemporary fitted kitchen. Capstan Way is a quiet residential location by Pearson's Park and within walking distance to Rotherhithe Overground station, Canada Water Tube Station (Jubilee Line & London Overground, Zone 2) and Hilton Pier for the Thames Clipper service. This property would suit first-time buyers, professional couples and landlords who wish to take advantage of the excellent transport links and the great local amenities. The property benefits from a long lease and an allocated car parking space.

Borough: Southwark\* Council Tax: B\* EPC: TBA Lease Term: 960 years\* Service Charge: £960\* Ground Rent: £20\*  
Nearest Station: Canada Water (0.73 miles) Material Information: [www.alexneil.com/material-information](http://www.alexneil.com/material-information)

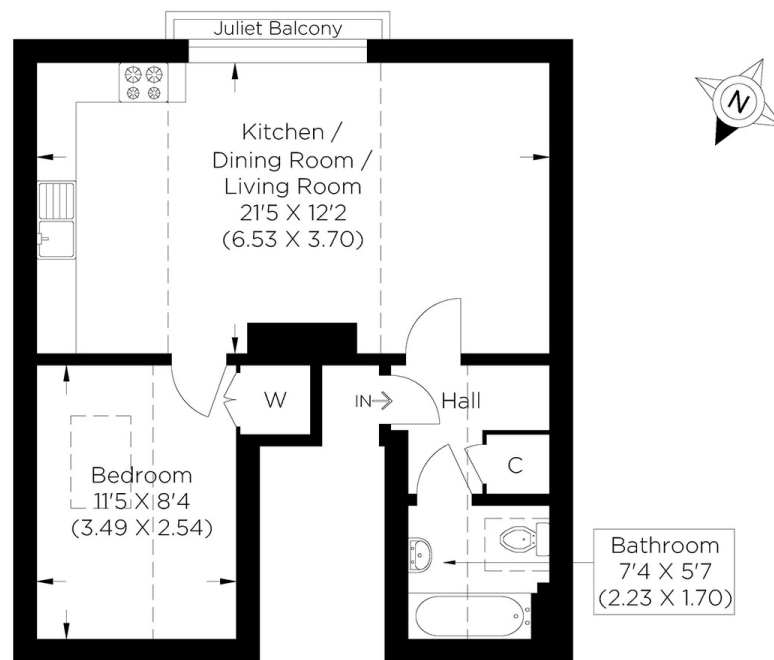

Second Floor  
Approximate gross internal area  
42.13 sq m / 453.48 sq ft

**Rotherhithe & Bermondsey Office**  
146 Lower Road, London SE16 2UG

t: 020 7237 6767 e: [rotherhithe@alexneil.com](mailto:rotherhithe@alexneil.com)

Disclaimer: Property descriptions are subjective and used in good faith as an opinion rather than statements of fact. The owner provided information relating to title, tenure, service charges and ground rent information. Therefore, please make specific enquiries to ensure that our descriptions match your expectations of the property. Floor plan measurements are approximate and for illustrative purposes only. Furthermore, we have not tested any services, systems or appliances at this property. And we strongly recommend that you verify all the provided information on inspection and that your surveyor and conveyancer further confirm details. Also, market conditions and property values regularly fluctuate. And showcased sold properties demonstrate our previous successes rather than indicate live property values. \*As advised by the owner. \*\*Property sold subject to contract.



# ALEX NEIL

ESTATE AGENTS SINCE 1984

2024 signifies our **40th Anniversary**, and we are immensely proud to have reached this impressive longevity milestone. In celebration, we launched an **exceptional promotion** for sellers, affording them increased marketing exposure for free!

**40 years of expertise:** With four decades of experience, we bring a wealth of knowledge and expertise. Our durability is a testament to the trust satisfied clients place in us. We understand the nuances of the diverse neighbourhoods we cover. Our local expertise allows us to provide tailored solutions, whether you're buying or selling, allowing you to move with confidence.



ALEX NEIL

ESTATE AGENTS SINCE 1984

[www.alexneil.com](http://www.alexneil.com)