



CHARLESWORTH HOUSE E14  
**2 bedroom apartment**

**£375,000**  
SOLD





# CHARLESWORTH HOUSE E14

A rarely available two bedroom apartment with direct outside space located within Charlesworth House, Dod Street, E14. The apartment benefits from high ceilings throughout and has been decorated to a high standard, creating the perfect home! The reception boasts floor to ceiling windows and doors leading to the patio, the kitchen and bathroom are both recently fitted and stylish. Well placed for Westferry DLR, Canary Wharf, the new Elizabeth Line station and the City are easily accessible. Excellent local amenities include shopping close by, plus Bartlett Park, gyms, bars, restaurants and cinemas. Early viewing is highly recommended.

Borough: Tower Hamlets\* Council Tax: C\* EPC: D Lease Term: 92\* Service Charge: £1,509\* Ground Rent: £10\*

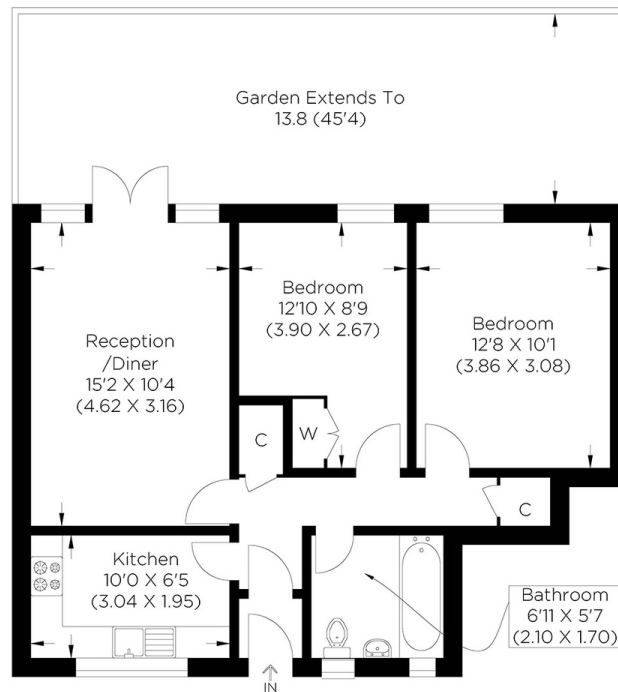

Approximate gross internal area  
57.29 sq m / 616.66 sq ft



**Canary Wharf & Docklands Office**  
**2 Westferry Road, Canary Wharf, London E14 8JT**

**t: 020 7537 9859 e: [canarywharf@alexneil.com](mailto:canarywharf@alexneil.com)**

Disclaimer: Property descriptions are subjective and used in good faith as an opinion rather than statements of fact. The owner provided information relating to title, tenure, service charges and ground rent information. Therefore, please make specific enquiries to ensure that our descriptions match your expectations of the property. Floor plan measurements are approximate and for illustrative purposes only. Furthermore, we have not tested any services, systems or appliances at this property. And we strongly recommend that you verify all the provided information on inspection and that your surveyor and conveyancer further confirm details. Also, market conditions and property values regularly fluctuate. And showcased sold properties demonstrate our previous successes rather than indicate live property values. \*As advised by the owner. \*\*Property sold subject to contract.

## ALEX NEIL

ESTATE AGENTS SINCE 1984