



FOLLETT STREET E14
1 bedroom apartment

£375,000
SOLD



FOLLETT STREET E14

This well-proportioned one-bedroom apartment is in a well-maintained period conversion on Follett Street, Poplar, E14. The spacious apartment comprises a large lounge with stunning features, including high ceilings and a separate kitchen, complemented by skylights and leading to your private outside space. The bedroom provides plenty of floor space, a spacious bathroom, and, uniquely, a large basement, which is perfect for storage. Follett Street boasts a fantastic location with All Saints DLR station, affording excellent transport links and access for the full enjoyment of the plethora of shops, restaurants, and bars that Canary Wharf provides. This superb apartment is offered chain-free and will only be available for a short time.

Borough: Tower Hamlets* Council Tax: B* EPC: D Lease Term: 248 years* Service Charge: £1,200* Ground Rent: TBA
Nearest Station: All Saints (0.12 miles) Material Information: www.alexneil.com/material-information

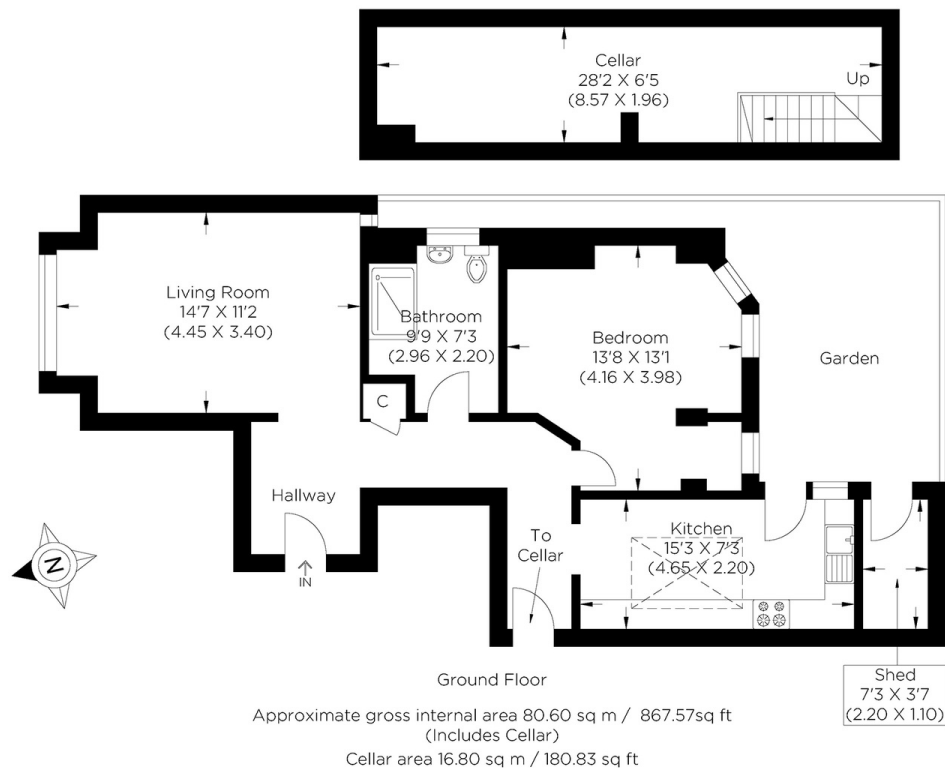

Canary Wharf & Docklands Office
2 Westferry Road, Canary Wharf, London E14 8JT

t: 020 7537 9859 e: canarywharf@alexneil.com

Disclaimer: Property descriptions are subjective and used in good faith as an opinion rather than statements of fact. The owner provided information relating to title, tenure, service charges and ground rent information. Therefore, please make specific enquiries to ensure that our descriptions match your expectations of the property. Floor plan measurements are approximate and for illustrative purposes only. Furthermore, we have not tested any services, systems or appliances at this property. And we strongly recommend that you verify all the provided information on inspection and that your surveyor and conveyancer further confirm details. Also, market conditions and property values regularly fluctuate. And showcased sold properties demonstrate our previous successes rather than indicate live property values. *As advised by the owner. **Property sold subject to contract.



ALEX NEIL

ESTATE AGENTS SINCE 1984