



MERCER COURT E1
2 bedroom apartment

£400,000
SOLD



MERCER COURT E1

We present a large two-bedroom apartment in modern Mercer Court, Candle Street, E1. Mercer Court is a perfect location between Stepney Green and Mile End underground train stations allowing an easy commute through London. The apartment offers its new owners the perfect combination of space and natural light, ideal for those looking to work from home. You can enjoy the sun through the Juliette balcony or take a walk to the nearby Mile End Park, or just a little further, you have Victoria Park. This apartment is modern throughout and perfect for first-time buyers or investors. You'll want to view this home personally to appreciate the attributes and location fully.

Borough: Tower Hamlets* Council Tax: D* EPC: D Lease Term: 110* Service Charge: £825* Ground Rent: £350*

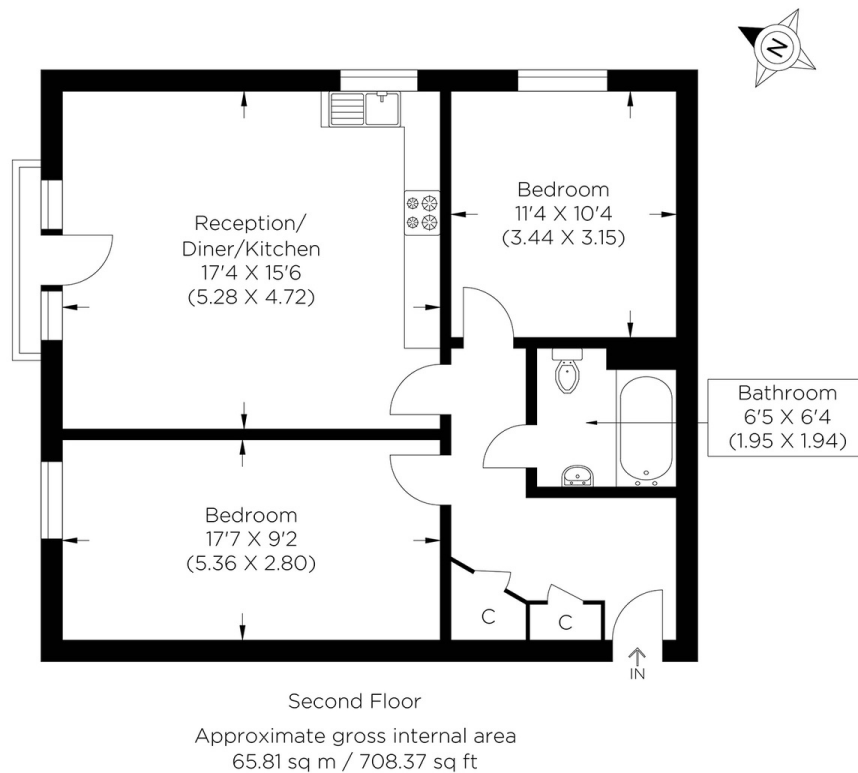

Canary Wharf & Docklands Office
2 Westferry Road, Canary Wharf, London E14 8JT

t: 020 7537 9859 e: canarywharf@alexneil.com

Disclaimer: Property descriptions are subjective and used in good faith as an opinion rather than statements of fact. The owner provided information relating to title, tenure, service charges and ground rent information. Therefore, please make specific enquiries to ensure that our descriptions match your expectations of the property. Floor plan measurements are approximate and for illustrative purposes only. Furthermore, we have not tested any services, systems or appliances at this property. And we strongly recommend that you verify all the provided information on inspection and that your surveyor and conveyancer further confirm details. Also, market conditions and property values regularly fluctuate. And showcased sold properties demonstrate our previous successes rather than indicate live property values. *As advised by the owner. **Property sold subject to contract.

ALEX NEIL

ESTATE AGENTS SINCE 1984