



TELEGRAPH PLACE E14  
**1 bedroom apartment**

**£325,000**  
SOLD





# TELEGRAPH PLACE E14

This well-presented one-bedroom apartment in Telegraph Place, Isle of Dogs E14, is on the top floor of a dockside development. The property briefly comprises a well-appointed lounge leading to a separate modern kitchen, a main bedroom and a stylish bathroom suite. Situated within the popular Mill Quay Development, affording easy access to the Millwall Dock, the perfect setting for a relaxing stroll or a scenic run. Telegraph Place is also conveniently located for Mudchute DLR Station with links to Canary Wharf and Greenwich. The apartment benefits from modern decor throughout, storage space and off-street parking.

Borough: Tower Hamlets\* Council Tax: C\* EPC: TBA Lease Term: 163 years\* Service Charge: £1,800\* Ground Rent: TBA  
Nearest Station: Mudchute (0.22 miles) Material Information: [www.alexneil.com/material-information](http://www.alexneil.com/material-information)

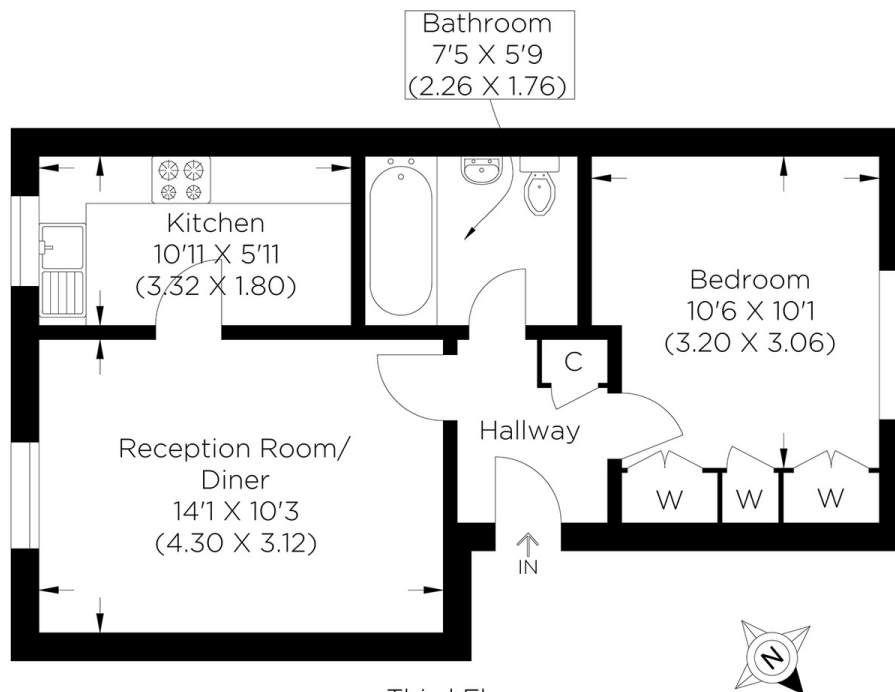

Third Floor  
Approximate gross internal area  
39.90 sq m / 429.48 sq ft

**Canary Wharf & Docklands Office**  
2 Westferry Road, Canary Wharf, London E14 8JT

t: 020 7537 9859 e: [canarywharf@alexneil.com](mailto:canarywharf@alexneil.com)

Disclaimer: Property descriptions are subjective and used in good faith as an opinion rather than statements of fact. The owner provided information relating to title, tenure, service charges and ground rent information. Therefore, please make specific enquiries to ensure that our descriptions match your expectations of the property. Floor plan measurements are approximate and for illustrative purposes only. Furthermore, we have not tested any services, systems or appliances at this property. And we strongly recommend that you verify all the provided information on inspection and that your surveyor and conveyancer further confirm details. Also, market conditions and property values regularly fluctuate. And showcased sold properties demonstrate our previous successes rather than indicate live property values. \*As advised by the owner. \*\*Property sold subject to contract.



## ALEX NEIL

ESTATE AGENTS SINCE 1984

2024 signifies our **40th Anniversary**, and we are immensely proud to have reached this impressive longevity milestone. In celebration, we launched an **exceptional promotion** for sellers, affording them increased marketing exposure for free!

**40 years of expertise:** With four decades of experience, we bring a wealth of knowledge and expertise. Our durability is a testament to the trust satisfied clients place in us. We understand the nuances of the diverse neighbourhoods we cover. Our local expertise allows us to provide tailored solutions, whether you're buying or selling, allowing you to move with confidence.



ALEX NEIL

ESTATE AGENTS SINCE 1984

[www.alexneil.com](http://www.alexneil.com)