



VERWOOD LODGE E14
2 bedroom apartment

£400,000
SOLD



VERWOOD LODGE E14

We present a beautiful two-bedroom apartment in Verwood Lodge, Manchester Road, Isle of Dogs E14. Light and airy throughout, the apartment's entry is an inviting hallway sweeping around to an open plan living space opening to a modern kitchen area. Furthermore, there are two double bedrooms, a three-piece bathroom, and plenty of storage. The apartment benefits from parking and a garage, a long lease and is being sold chain free. Verwood Lodge is within effortless reach of many local shops and amenities on Manchester Road, the fashionable area of Canary Wharf, the open green open spaces of Mudchute Park, and the banks of the River Thames. Verwood Lodge enjoys excellent transport links, including buses and the river bus. And within easy reach of Crossharbour and Mudchute DLR stations. The property benefits from neutral decor, and this excellent apartment is ready to move into or represents an investment opportunity.

Borough: Tower Hamlets* Council Tax: D* EPC: C Lease Term: 900 years* Service Charge: £1,130* Ground Rent: £50*
Nearest Station: Mudchute (0.37 miles) Material Information: www.alexneil.com/material-information

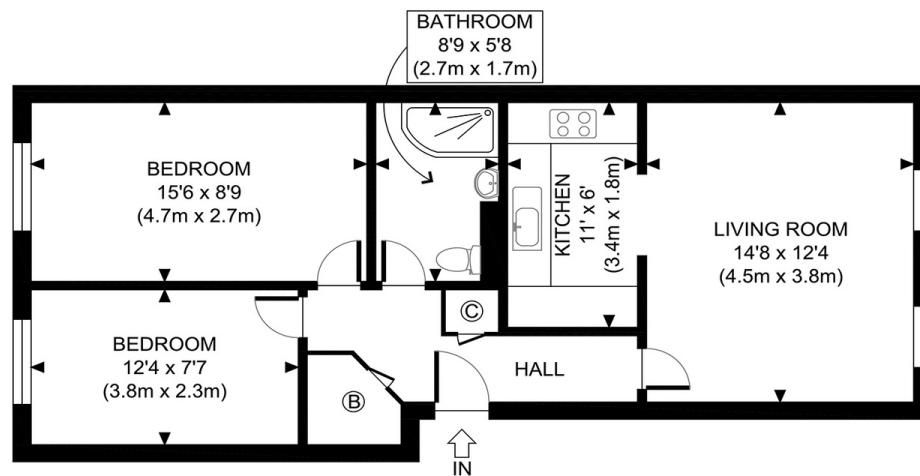

GROUND FLOOR
GROSS INTERNAL
FLOOR AREA 633 SQ FT



APPROX. GROSS INTERNAL FLOOR AREA 633 SQ FT / 59 SQM



Canary Wharf & Docklands Office
2 Westferry Road, Canary Wharf, London E14 8JT

t: 020 7537 9859 e: canarywharf@alexneil.com

Disclaimer: Property descriptions are subjective and used in good faith as an opinion rather than statements of fact. The owner provided information relating to title, tenure, service charges and ground rent information. Therefore, please make specific enquiries to ensure that our descriptions match your expectations of the property. Floor plan measurements are approximate and for illustrative purposes only. Furthermore, we have not tested any services, systems or appliances at this property. And we strongly recommend that you verify all the provided information on inspection and that your surveyor and conveyancer further confirm details. Also, market conditions and property values regularly fluctuate. And showcased sold properties demonstrate our previous successes rather than indicate live property values. *As advised by the owner. **Property sold subject to contract.

ALEX NEIL

ESTATE AGENTS SINCE 1984