



PAVILIONS COURT E15  
**1 bedroom apartment**

**£375,000**  
SOLD





# PAVILIONS COURT E15

This well-positioned Pavilions Court one-bedroom apartment is in the highly anticipated Bellway's Legacy Wharf, Cooks Road, Stratford E15 development. The third-floor apartment combines comfort and style and boasts a large open-plan kitchen lounge with direct access to a large private balcony with views over the inner courtyard, a sumptuous double bedroom and a modern bathroom. The property also offers floor-to-ceiling windows, ample storage and a spacious entrance. Legacy Wharf benefits from a concierge service, a gym, communal gardens and a roof terrace. The apartment is in an increasingly sought-after residential area of East London, within walking distance of Hackney Wick, Victoria Park and Bow. Legacy Wharf offers many local amenities, such as cafes, shops, Westfield Shopping Centre, and the Olympic Park. Pavilions Court is a short walk from Pudding Mill DLR Station and Stratford Underground Station.

Borough: Newham\* Council Tax: C\* EPC: B Lease Term: 996 years\* Service Charge: £1,950\* Ground Rent: £300\*  
Nearest Station: Pudding Mill Lane (0.19 miles) Material Information: [www.alexneil.com/material-information](http://www.alexneil.com/material-information)

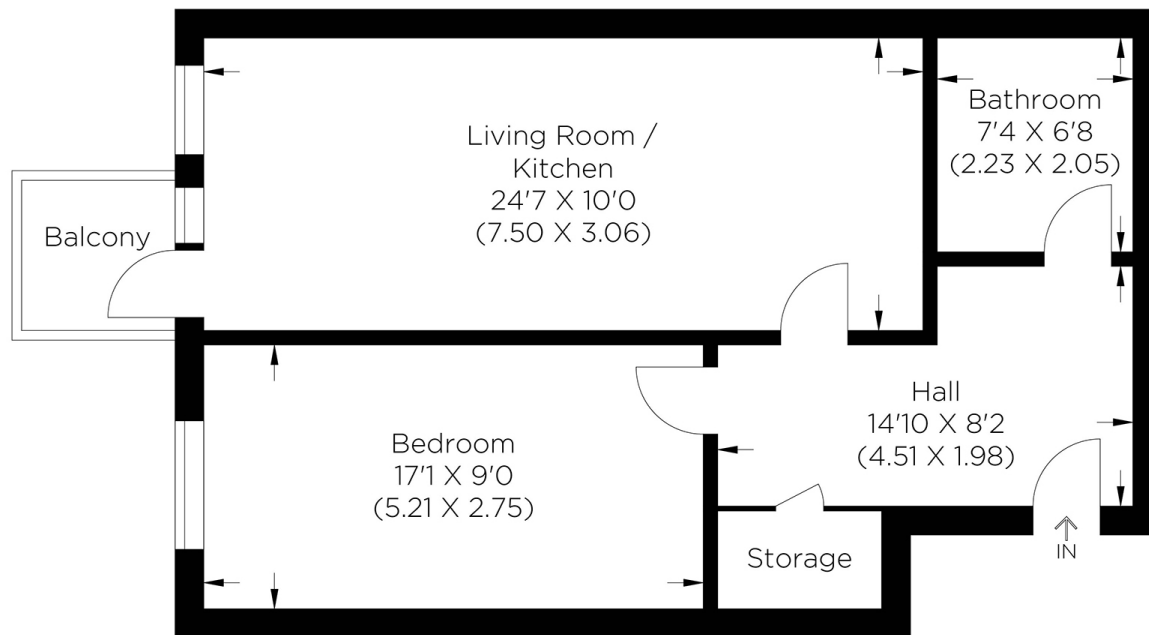

Approximate gross internal area  
54.85 sq m / 590.40 sq ft

**Canary Wharf & Docklands Office**  
**2 Westferry Road, Canary Wharf, London E14 8JT**

**t: 020 7537 9859 e: [canarywharf@alexneil.com](mailto:canarywharf@alexneil.com)**

Disclaimer: Property descriptions are subjective and used in good faith as an opinion rather than statements of fact. The owner provided information relating to title, tenure, service charges and ground rent information. Therefore, please make specific enquiries to ensure that our descriptions match your expectations of the property. Floor plan measurements are approximate and for illustrative purposes only. Furthermore, we have not tested any services, systems or appliances at this property. And we strongly recommend that you verify all the provided information on inspection and that your surveyor and conveyancer further confirm details. Also, market conditions and property values regularly fluctuate. And showcased sold properties demonstrate our previous successes rather than indicate live property values. \*As advised by the owner. \*\*Property sold subject to contract.



## ALEX NEIL

ESTATE AGENTS SINCE 1984

2024 signifies our **40th Anniversary**, and we are immensely proud to have reached this impressive longevity milestone. In celebration, we launched an **exceptional promotion** for sellers, affording them increased marketing exposure for free!

**40 years of expertise:** With four decades of experience, we bring a wealth of knowledge and expertise. Our durability is a testament to the trust satisfied clients place in us. We understand the nuances of the diverse neighbourhoods we cover. Our local expertise allows us to provide tailored solutions, whether you're buying or selling, allowing you to move with confidence.



ALEX NEIL

ESTATE AGENTS SINCE 1984

[www.alexneil.com](http://www.alexneil.com)