



PORT HOUSE E14
2 bedroom apartment

£475,000
SOLD



PORT HOUSE E14

We present a fantastic opportunity to acquire a charming and characterful two-bedroom apartment set within the highly esteemed Port House, Burrells Wharf Square, Isle of Dogs E14. This larger-than-average apartment is in pristine condition and comprises an open-plan reception room with a private balcony with views towards the River Thames, providing a wonderful space to entertain or start the day with a coffee. A stylish galley-style kitchen overlooks the reception room, and there is a spacious main bedroom, a second double bedroom and a refurbished family bathroom. Located just a short distance from Canary Wharf, Burrells Wharf is one of E14's most desirable developments, making this an ideal property for maintaining an excellent work-life balance. Further benefits include a concierge service, fantastic residents' leisure facilities and a share of freehold.

Borough: Tower Hamlets* Council Tax: E* EPC: C Lease Term: 92* Service Charge: £3,950* Ground Rent: £10*

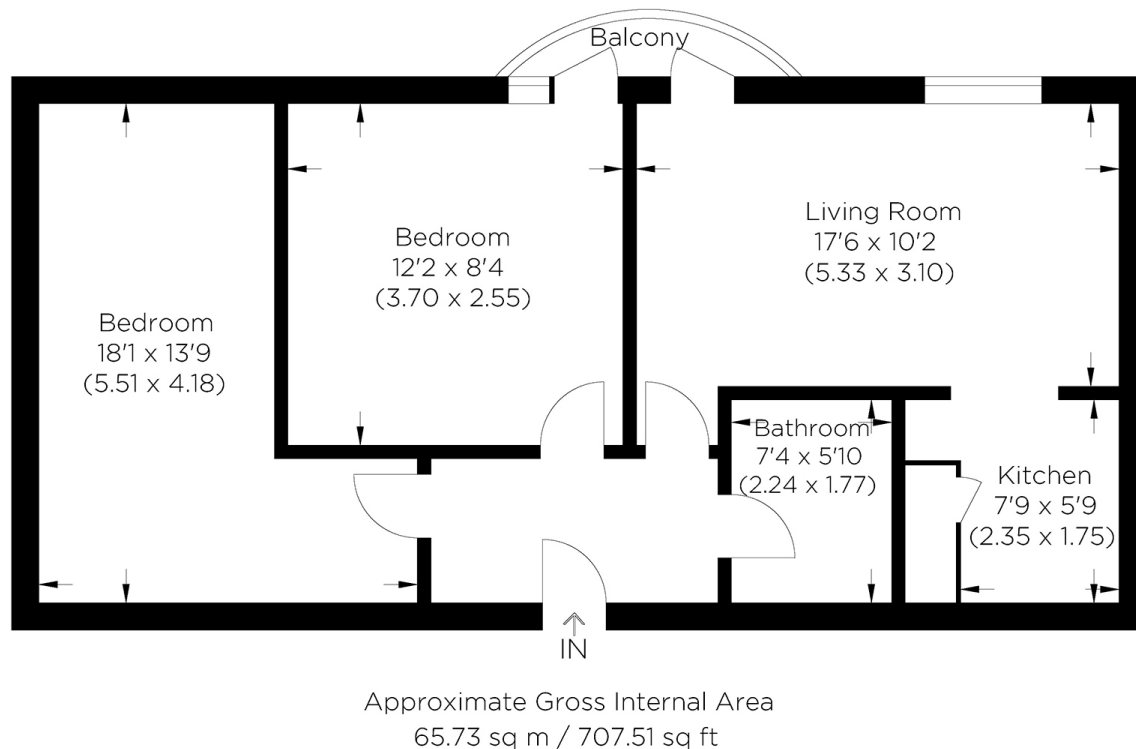

Canary Wharf & Docklands Office
2 Westferry Road, Canary Wharf, London E14 8JT

t: 020 7537 9859 e: canarywharf@alexneil.com

Disclaimer: Property descriptions are subjective and used in good faith as an opinion rather than statements of fact. The owner provided information relating to title, tenure, service charges and ground rent information. Therefore, please make specific enquiries to ensure that our descriptions match your expectations of the property. Floor plan measurements are approximate and for illustrative purposes only. Furthermore, we have not tested any services, systems or appliances at this property. And we strongly recommend that you verify all the provided information on inspection and that your surveyor and conveyancer further confirm details. Also, market conditions and property values regularly fluctuate. And showcased sold properties demonstrate our previous successes rather than indicate live property values. *As advised by the owner. **Property sold subject to contract.



ALEX NEIL

ESTATE AGENTS SINCE 1984