



GRAY COURT E1  
**1 bedroom apartment**

**£350,000**  
SOLD





# GRAY COURT E1

This immaculate and beautifully presented one-bedroom apartment beside the Regents Canal is in charming Gray Court on Candle Street, Stepney Green E1. Comprising of a generous space with a large living room and kitchen, all finished to a high standard, a larger than average double bedroom and a modern family bathroom. The apartment has stunning views of the Canal and underground parking. Residents can also enjoy the scenic communal gardens steeped in history with access to Regents Canal, providing a lovely walk towards Victoria Park and Islington. Candle Street's ideal location is close to Mile End, Stepney Green tube stations, and Limehouse DLR. It boasts easy access to local amenities and green spaces such as Mile End Park and Victoria Park. We highly recommend booking your appointment to view it.

Borough: Tower Hamlets\* Council Tax: C\* EPC: TBA Lease Term: 111\* Service Charge: £1,934\* Ground Rent: £150\*

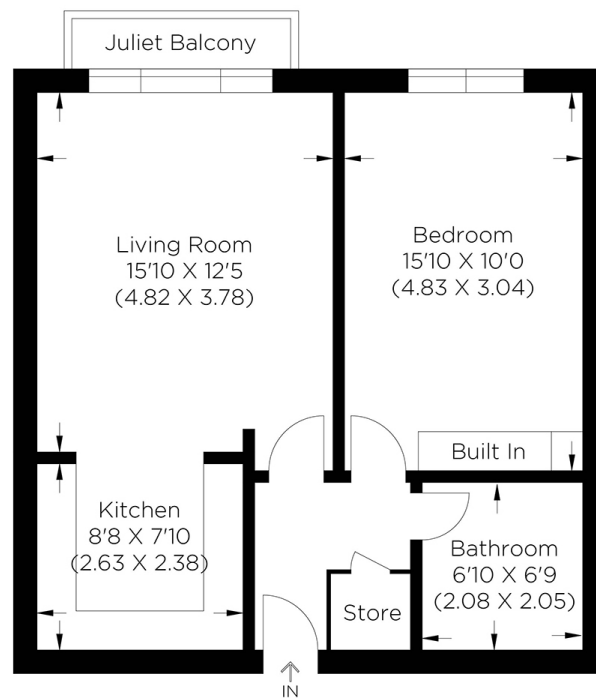

Approximate gross internal area  
49.63 sq m / 534.21 sq ft

**Canary Wharf & Docklands Office**  
**2 Westferry Road, Canary Wharf, London E14 8JT**

**t: 020 7537 9859 e: [canarywharf@alexneil.com](mailto:canarywharf@alexneil.com)**

Disclaimer: Property descriptions are subjective and used in good faith as an opinion rather than statements of fact. The owner provided information relating to title, tenure, service charges and ground rent information. Therefore, please make specific enquiries to ensure that our descriptions match your expectations of the property. Floor plan measurements are approximate and for illustrative purposes only. Furthermore, we have not tested any services, systems or appliances at this property. And we strongly recommend that you verify all the provided information on inspection and that your surveyor and conveyancer further confirm details. Also, market conditions and property values regularly fluctuate. And showcased sold properties demonstrate our previous successes rather than indicate live property values. \*As advised by the owner. \*\*Property sold subject to contract.



# ALEX NEIL

ESTATE AGENTS SINCE 1984