



NELSON WALK E3  
**1 bedroom apartment**

**£325,000**  
SOLD





# NELSON WALK E3

This one-bedroom apartment is on the exquisite Nelson Walk, Bow E3. The property offers a contemporary feel throughout, consisting of a stylish open-plan lounge room/kitchen, which also leads to a large private balcony perfect for al fresco dining, one double bedroom and a modern family bathroom. The development has been well thought out and boasts excellent resident facilities, including an on-site gymnasium, local Sainsbury's, concierge services, and bike storage. Nelson Walk is convenient for transport, including Bromley By Bow (District and Hammersmith & City line Zone 2) and Devons Road DLR allowing for swift access to the City, Canary Wharf, West End and beyond. The apartment also enjoys easy access to an array of local amenities affording the utmost convenience. We recommend your earliest viewing.

Borough: Tower Hamlets\* Council Tax: C\* EPC: B Lease Term: 114\* Service Charge: £1,400\* Ground Rent: £250\*

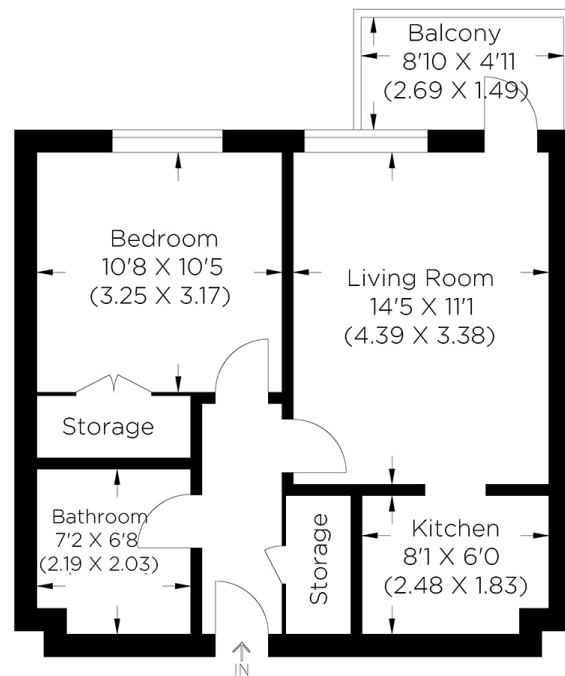

Approximate gross internal area  
42.86 sq m / 461.30 sq ft

**Canary Wharf & Docklands Office**  
2 Westferry Road, Canary Wharf, London E14 8JT

t: 020 7537 9859 e: [canarywharf@alexneil.com](mailto:canarywharf@alexneil.com)

Disclaimer: Property descriptions are subjective and used in good faith as an opinion rather than statements of fact. The owner provided information relating to title, tenure, service charges and ground rent information. Therefore, please make specific enquiries to ensure that our descriptions match your expectations of the property. Floor plan measurements are approximate and for illustrative purposes only. Furthermore, we have not tested any services, systems or appliances at this property. And we strongly recommend that you verify all the provided information on inspection and that your surveyor and conveyancer further confirm details. Also, market conditions and property values regularly fluctuate. And showcased sold properties demonstrate our previous successes rather than indicate live property values. \*As advised by the owner. \*\*Property sold subject to contract.



## ALEX NEIL

ESTATE AGENTS SINCE 1984