



GOODWIN CLOSE SE16
2 bedroom apartment

£360,000
SOLD



GOODWIN CLOSE SE16

A spacious two-bedroom apartment is available in convenient Goodwin Close, Bermondsey SE16. The local high street is proximate, as is Bermondsey Jubilee Line Station. This modern home is bright and spacious, comprising a large living room, a fitted kitchen, two double bedrooms and a bathroom. Additionally, there is laminate wood flooring and ample storage space. Residents enjoy access to communal gardens and residents car parks. Bermondsey Underground Station is two stops from Canary Wharf business and retail plaza. Furthermore, regular local buses provide alternative transport options and increase convenience. Book your viewing appointment today.

Borough: Southwark* Council Tax: C* EPC: TBA Lease Term: 160* Service Charge: £1,000* Ground Rent: TBA

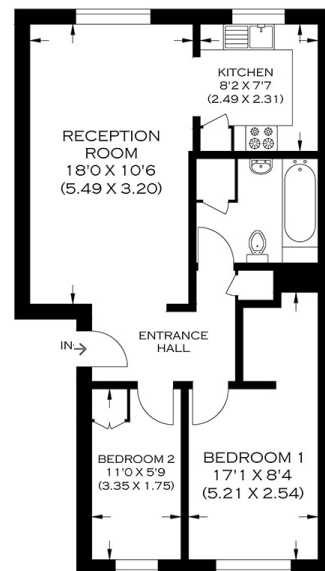

GROUND FLOOR

APPROXIMATE GROSS INTERNAL AREA
52.80 SQ M / 569.0 SQ FT

Produced By www.myphotogenie.co.uk

Rotherhithe & Bermondsey Office
146 Lower Road, London SE16 2UG

t: 020 7237 6767 e: rotherhithe@alexneil.com

Disclaimer: Property descriptions are subjective and used in good faith as an opinion rather than statements of fact. The owner provided information relating to title, tenure, service charges and ground rent information. Therefore, please make specific enquiries to ensure that our descriptions match your expectations of the property. Floor plan measurements are approximate and for illustrative purposes only. Furthermore, we have not tested any services, systems or appliances at this property. And we strongly recommend that you verify all the provided information on inspection and that your surveyor and conveyancer further confirm details. Also, market conditions and property values regularly fluctuate. And showcased sold properties demonstrate our previous successes rather than indicate live property values. *As advised by the owner. **Property sold subject to contract.



ALEX NEIL

ESTATE AGENTS SINCE 1984