



CLIPPER HOUSE E14
2 bedroom duplex apartment

£375,000
SOLD



CLIPPER HOUSE E14

A well presented and spacious maisonette arranged over two floors and enviably situated in Clipper House, Manchester Road, Isle of Dogs E14. The combination of striking presentation with elegant touches and the vibrancy of a bespoke contemporary home make this an ideal offering. This split level apartment comprises of a generous living/entertaining space, private balcony, stylish kitchen/diner, two double bedrooms, a modern bathroom and ample storage throughout. Clipper House has access to well maintained communal gardens and is situated on Manchester Road allowing easy access to the River Thames, Island Gardens DLR station, Greenwich Foot Tunnel and Mudchute Farm. Canary Wharf is just a few DLR stops away hosting an array of ever-changing amenities. Early viewing is highly recommended for this beautiful home.

Borough: Tower Hamlets* Council Tax: C* EPC: D Lease Term: 92 years* Service Charge: £960* Ground Rent: £10*
Nearest Station: Island Gardens (0.06 miles) Material Information: www.alexneil.com/material-information

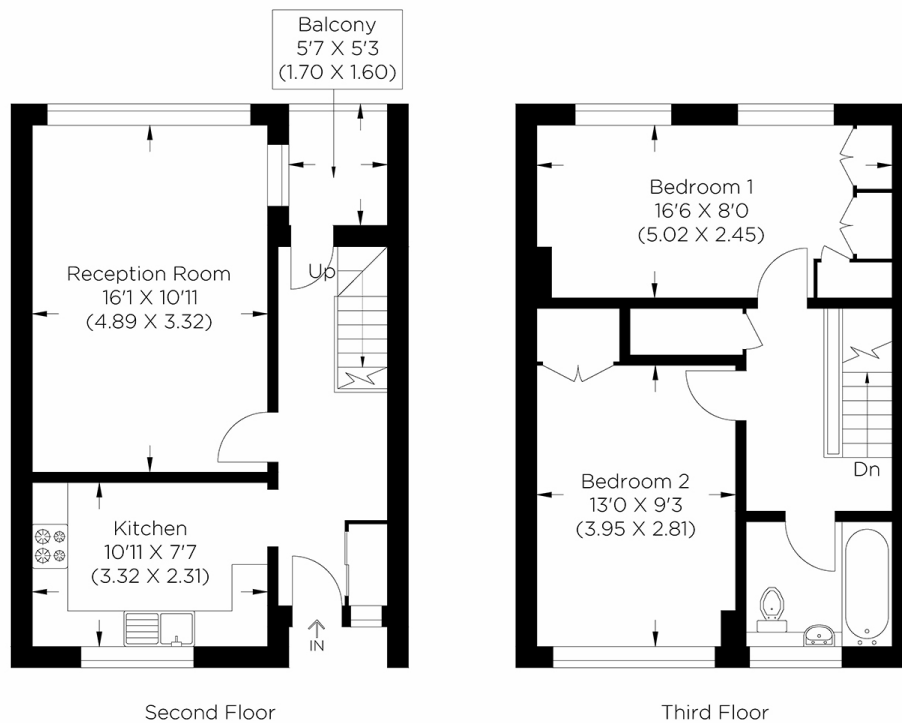

Approximate gross internal area
70.60 sq m / 760.0 sq ft



Canary Wharf & Docklands Office
2 Westferry Road, Canary Wharf, London E14 8JT

t: 020 7537 9859 e: canarywharf@alexneil.com

Disclaimer: Property descriptions are subjective and used in good faith as an opinion rather than statements of fact. The owner provided information relating to title, tenure, service charges and ground rent information. Therefore, please make specific enquiries to ensure that our descriptions match your expectations of the property. Floor plan measurements are approximate and for illustrative purposes only. Furthermore, we have not tested any services, systems or appliances at this property. And we strongly recommend that you verify all the provided information on inspection and that your surveyor and conveyancer further confirm details. Also, market conditions and property values regularly fluctuate. And showcased sold properties demonstrate our previous successes rather than indicate live property values. *As advised by the owner. **Property sold subject to contract.

ALEX NEIL

ESTATE AGENTS SINCE 1984