



COWAN HOUSE SE10  
**2 bedroom apartment**

**£550,000**  
SOLD





# COWAN HOUSE SE10

This beautifully presented two-bedroom apartment is in Cowan House, Greenwich High Road, Greenwich SE10, forming part of the gated, highly anticipated Hope Wharf development. This unique apartment is offered with no onward chain and is neutrally decorated throughout. The accommodation comprises a large open-plan living room with a delightful private balcony and an additional large private terrace offering unparalleled views over the City, a state-of-the-art kitchen with integrated appliances, two double bedrooms and a family bathroom. Further benefits include ample storage, wooden flooring, floor-to-ceiling windows allowing plenty of natural light throughout and a rare allocated parking space. Hope Wharf is close to historic Greenwich, with abundant boutique shops and the perfect setting for drinks with friends and calming river views.

Borough: Royal Greenwich\* Council Tax: D\* EPC: B Lease Term: 246 years\* Service Charge: £1,300\* Ground Rent: £450\*  
Nearest Station: Deptford Bridge (0.13 miles) Material Information: [www.alexneil.com/material-information](http://www.alexneil.com/material-information)

Approximate Gross Internal Area  
75.10 sq m / 808.0 sq ft

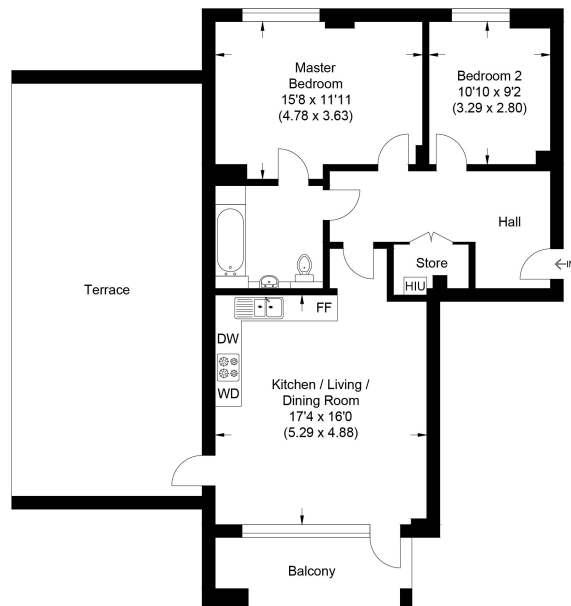

Illustration for identification purposes only, measurements are approximate, not to scale.

**Rotherhithe & Bermondsey Office**  
146 Lower Road, London SE16 2UG

t: 020 7237 6767 e: [rotherhithe@alexneil.com](mailto:rotherhithe@alexneil.com)

Disclaimer: Property descriptions are subjective and used in good faith as an opinion rather than statements of fact. The owner provided information relating to title, tenure, service charges and ground rent information. Therefore, please make specific enquiries to ensure that our descriptions match your expectations of the property. Floor plan measurements are approximate and for illustrative purposes only. Furthermore, we have not tested any services, systems or appliances at this property. And we strongly recommend that you verify all the provided information on inspection and that your surveyor and conveyancer further confirm details. Also, market conditions and property values regularly fluctuate. And showcased sold properties demonstrate our previous successes rather than indicate live property values. \*As advised by the owner. \*\*Property sold subject to contract.



# ALEX NEIL

ESTATE AGENTS SINCE 1984

2024 signifies our **40th Anniversary**, and we are immensely proud to have reached this impressive longevity milestone. In celebration, we launched an **exceptional promotion** for sellers, affording them increased marketing exposure for free!

**40 years of expertise:** With four decades of experience, we bring a wealth of knowledge and expertise. Our durability is a testament to the trust satisfied clients place in us. We understand the nuances of the diverse neighbourhoods we cover. Our local expertise allows us to provide tailored solutions, whether you're buying or selling, allowing you to move with confidence.



ALEX NEIL

ESTATE AGENTS SINCE 1984

[www.alexneil.com](http://www.alexneil.com)