



DRAKE HALL E16
2 bedroom apartment

£325,000
SOLD



DRAKE HALL E16

Available to the market is this top-floor, two-bedroom apartment set within Drake Hall, Wesley Avenue, Silvertown E16, forming part of the popular Britannia Village development. The property comprises a semi-open plan kitchen/lounge with large windows filling the room with lots of natural light, two large bedrooms, the master with direct access to a balcony and a modern three-piece bathroom. Further benefiting from a designated parking space, direct access to a large loft and ample storage space throughout the property. Drake Hall is close to the water, with amazing views of the O2 Arena and the Canary Wharf skyline. West Silvertown DLR station provides excellent travel connections, giving access to Bank in approximately 20 minutes, Canary Wharf within 10 minutes, and Emirates Cable Car offers a scenic journey.

Borough: Newham* Council Tax: C* EPC: TBA Lease Term: 979* Service Charge: £2,700* Ground Rent: £10*

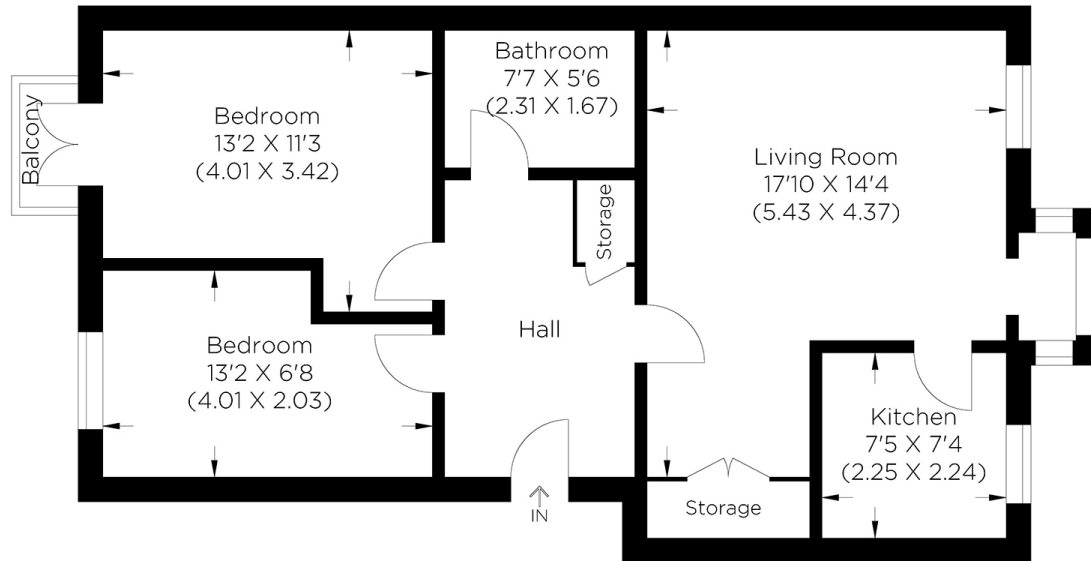

Approximate gross internal area
64.02 sq m / 689.10 sq ft

Canary Wharf & Docklands Office
2 Westferry Road, Canary Wharf, London E14 8JT

t: 020 7537 9859 e: canarywharf@alexneil.com

Disclaimer: Property descriptions are subjective and used in good faith as an opinion rather than statements of fact. The owner provided information relating to title, tenure, service charges and ground rent information. Therefore, please make specific enquiries to ensure that our descriptions match your expectations of the property. Floor plan measurements are approximate and for illustrative purposes only. Furthermore, we have not tested any services, systems or appliances at this property. And we strongly recommend that you verify all the provided information on inspection and that your surveyor and conveyancer further confirm details. Also, market conditions and property values regularly fluctuate. And showcased sold properties demonstrate our previous successes rather than indicate live property values. *As advised by the owner. **Property sold subject to contract.



ALEX NEIL

ESTATE AGENTS SINCE 1984