



MENAI PLACE E3
2 bedroom apartment

£375,000
SOLD



MENAI PLACE E3

A stunningly presented two-bedroom apartment set within Menai Place, Bow E3, a highly sought-after private gated development. This contemporary, bright and spacious property comprises an open-plan kitchen featuring fitted appliances and a breakfast bar leading to a spacious reception room, two double bedrooms and a modern family bathroom. Menai Place boasts manicured gardens and is a short stroll to Bow Church DLR and Bow Road (District/Hammersmith & City Lines). Additionally, it is close to local shopping amenities and the vibrant, popular bars, restaurants and cafes of Canary Wharf, Westfield Stratford and the O2 Arena. The commute into Canary Wharf and the City is a short journey, and Bow is close to many green spaces and cycle paths, including the lovely Victoria Park, Three Mills Park, Limehouse Canal and Olympic Park. We highly recommend booking an appointment to view this home.

Borough: Tower Hamlets* Council Tax: C* EPC: TBA Lease Term: 189* Service Charge: £1,092* Ground Rent: TBA

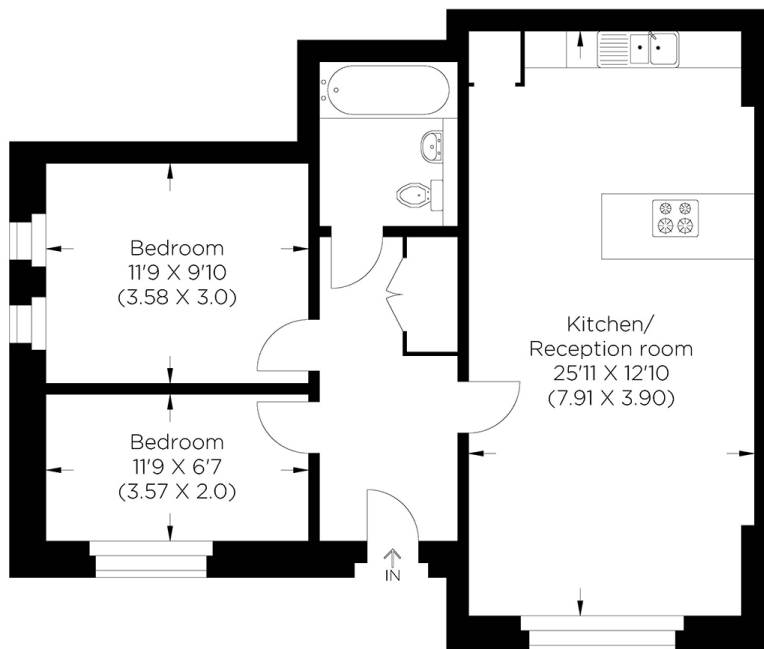

Approximate gross internal area
63.57 sq m / 684.0 sq ft

Canary Wharf & Docklands Office
2 Westferry Road, Canary Wharf, London E14 8JT

t: 020 7537 9859 e: canarywharf@alexneil.com

Disclaimer: Property descriptions are subjective and used in good faith as an opinion rather than statements of fact. The owner provided information relating to title, tenure, service charges and ground rent information. Therefore, please make specific enquiries to ensure that our descriptions match your expectations of the property. Floor plan measurements are approximate and for illustrative purposes only. Furthermore, we have not tested any services, systems or appliances at this property. And we strongly recommend that you verify all the provided information on inspection and that your surveyor and conveyancer further confirm details. Also, market conditions and property values regularly fluctuate. And showcased sold properties demonstrate our previous successes rather than indicate live property values. *As advised by the owner. **Property sold subject to contract.



ALEX NEIL

ESTATE AGENTS SINCE 1984