



CHART HOUSE E14  
**studio apartment**

**£350,000**  
SOLD





# CHART HOUSE E14

We offer this beautifully presented studio apartment in the Chart House, Burrells Wharf Square, Isle of Dogs E14. Historic Burrells Wharf Square enjoys a peaceful riverside setting and is sought after by discerning buyers. This beautiful apartment boasts a state-of-the-art Miele kitchen and a spacious sleeping/living area with access to a private balcony with views of the Canary Wharf Skyline. There is a modern bathroom and secure underground parking. Burrells Wharf offers superb facilities, including a swimming pool, gym, spa and concierge service. Set perfectly for Mudchute DLR and Mast House Terrace Pier for the Thames Clipper, providing access to Canary Wharf, the O2 and Greenwich. There are an array of eateries and cosy pubs close to home, ideal for an impromptu meal out. This fantastic property is a perfect first-time purchase or pied-a-terre.

Borough: Tower Hamlets\* Council Tax: D\* EPC: C Lease Term: 92\* Service Charge: £2,750\* Ground Rent: £10\*

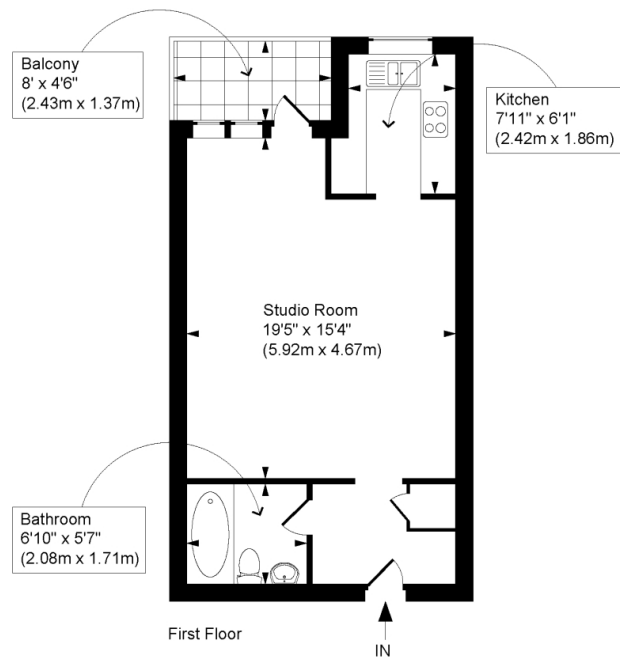

Approximate. Gross Internal Area: 421 Sq. Ft. / 39.1 Sq. M



**Canary Wharf & Docklands Office**  
2 Westferry Road, Canary Wharf, London E14 8JT

t: 020 7537 9859 e: [canarywharf@alexneil.com](mailto:canarywharf@alexneil.com)

Disclaimer: Property descriptions are subjective and used in good faith as an opinion rather than statements of fact. The owner provided information relating to title, tenure, service charges and ground rent information. Therefore, please make specific enquiries to ensure that our descriptions match your expectations of the property. Floor plan measurements are approximate and for illustrative purposes only. Furthermore, we have not tested any services, systems or appliances at this property. And we strongly recommend that you verify all the provided information on inspection and that your surveyor and conveyancer further confirm details. Also, market conditions and property values regularly fluctuate. And showcased sold properties demonstrate our previous successes rather than indicate live property values. \*As advised by the owner. \*\*Property sold subject to contract.

## ALEX NEIL

ESTATE AGENTS SINCE 1984