



JUPITER HOUSE E14
2 bedroom apartment

£475,000
SOLD



JUPITER HOUSE E14

This delightful two-bedroom apartment is in popular Jupiter House, Lockes Wharf, St. Davids Square, a riverside development on the Isle of Dogs E14. This spacious property comprises two double bedrooms, a modern family bathroom, a separate kitchen/breakfast room and a generous living space leading to a private balcony. The apartment benefits from an allocated parking space and on-site facilities, including a residents' gym, swimming pool and concierge services. St David's Square is close to local shops and amenities on Westferry Road, Canary Wharf and the River Thames. All transport links to the City and the West End are also within easy reach, offering the utmost convenience.

Borough: Tower Hamlets* Council Tax: E* EPC: C Lease Term: 976 years* Service Charge: £4,060* Ground Rent: £175*
Nearest Station: Island Gardens (0.26 miles) Material Information: www.alexneil.com/material-information

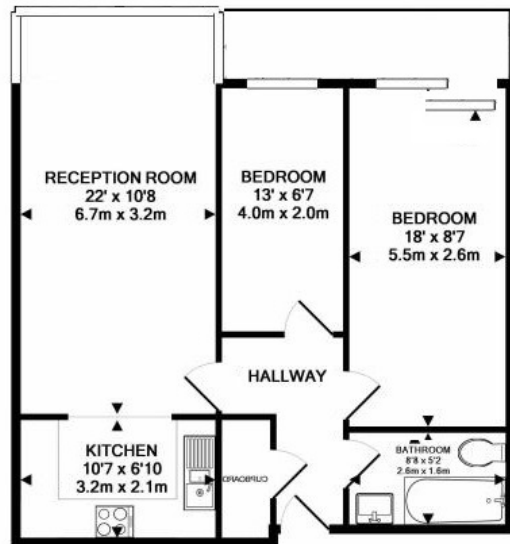

TOTAL APPROX. FLOOR AREA 680FT (63.2 SQ.M)

Canary Wharf & Docklands Office
2 Westferry Road, Canary Wharf, London E14 8JT

t: 020 7537 9859 e: canarywharf@alexneil.com

Disclaimer: Property descriptions are subjective and used in good faith as an opinion rather than statements of fact. The owner provided information relating to title, tenure, service charges and ground rent information. Therefore, please make specific enquiries to ensure that our descriptions match your expectations of the property. Floor plan measurements are approximate and for illustrative purposes only. Furthermore, we have not tested any services, systems or appliances at this property. And we strongly recommend that you verify all the provided information on inspection and that your surveyor and conveyancer further confirm details. Also, market conditions and property values regularly fluctuate. And showcased sold properties demonstrate our previous successes rather than indicate live property values. *As advised by the owner. **Property sold subject to contract.



ALEX NEIL

ESTATE AGENTS SINCE 1984

2024 signifies our **40th Anniversary**, and we are immensely proud to have reached this impressive longevity milestone. In celebration, we launched an **exceptional promotion** for sellers, affording them increased marketing exposure for free!

40 years of expertise: With four decades of experience, we bring a wealth of knowledge and expertise. Our durability is a testament to the trust satisfied clients place in us. We understand the nuances of the diverse neighbourhoods we cover. Our local expertise allows us to provide tailored solutions, whether you're buying or selling, allowing you to move with confidence.



ALEX NEIL

ESTATE AGENTS SINCE 1984

www.alexneil.com