



PAGES WALK SE1
4 bedroom terraced house

£850,000
SOLD



PAGES WALK SE1

A rare opportunity has arisen to acquire this stunning four-bedroom Victorian-style house in Pages Walk, Bermondsey SE1. The property is in an area rich in cultural venues and landmarks. There is an excellent selection of vibrant bars, restaurants and exquisite boutiques. After a recent refurbishment, this impeccable property benefits from a large reception/dining room with a fireplace and direct access to a low-maintenance private rear garden via French doors. There is a fully fitted kitchen, a main bedroom with an en-suite bathroom, three more double bedrooms and a modern bathroom. Additional benefits include two lofts, wooden floors, ample storage and central heating. This chain-free property is ideally located for Borough, Elephant & Castle and Bermondsey stations and has easy access to frequent bus services.

Borough: Southwark* Council Tax: E* EPC: TBA

Nearest Station: Elephant and Castle (0.73 miles) Material Information: www.alexneil.com/material-information

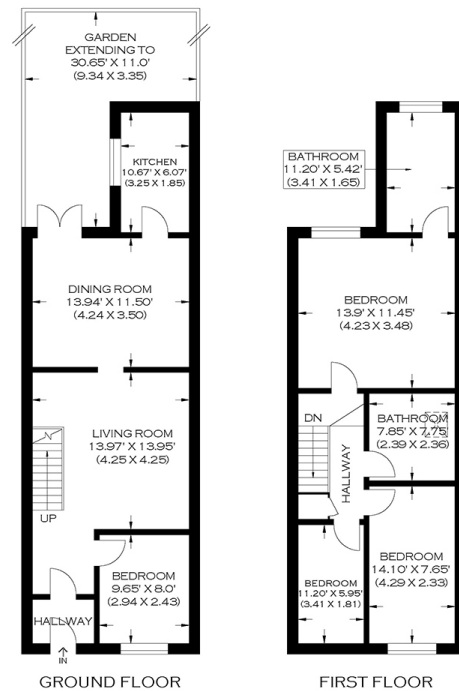

APPROXIMATE GROSS INTERNAL AREA
106.0 SQ M / 1140.97 SQ FT

PRODUCED BY WWW.MYPHOTOGENIE.CO.UK

Rotherhithe & Bermondsey Office
146 Lower Road, London SE16 2UG

t: 020 7237 6767 e: rotherhithe@alexneil.com

Disclaimer: Property descriptions are subjective and used in good faith as an opinion rather than statements of fact. The owner provided information relating to title, tenure, service charges and ground rent information. Therefore, please make specific enquiries to ensure that our descriptions match your expectations of the property. Floor plan measurements are approximate and for illustrative purposes only. Furthermore, we have not tested any services, systems or appliances at this property. And we strongly recommend that you verify all the provided information on inspection and that your surveyor and conveyancer further confirm details. Also, market conditions and property values regularly fluctuate. And showcased sold properties demonstrate our previous successes rather than indicate live property values. *As advised by the owner. **Property sold subject to contract.



ALEX NEIL

ESTATE AGENTS SINCE 1984

2024 signifies our **40th Anniversary**, and we are immensely proud to have reached this impressive longevity milestone. In celebration, we launched an **exceptional promotion** for sellers, affording them increased marketing exposure for free!

40 years of expertise: With four decades of experience, we bring a wealth of knowledge and expertise. Our durability is a testament to the trust satisfied clients place in us. We understand the nuances of the diverse neighbourhoods we cover. Our local expertise allows us to provide tailored solutions, whether you're buying or selling, allowing you to move with confidence.



ALEX NEIL

ESTATE AGENTS SINCE 1984

www.alexneil.com