



ROLT STREET SE8
2 bedroom apartment

£375,000
SOLD



ROLT STREET SE8

We present an excellent two-bedroom period conversion property in the tree-lined Rolt Street, Deptford SE8. The spacious apartment comprises a bright, airy reception room with a stunning bay window, a fully fitted kitchen, two double bedrooms, and a three-piece bathroom. The apartment also boasts storage space and a wonderful private garden, affording a superb area to entertain or relax after a long day. Rolt Street is a residential road conveniently located for Deptford's amenities and transport links, which offer excellent services into Central London and Canary Wharf.

Borough: Lewisham* Council Tax: B* EPC: TBA Lease Term: TBA Service Charge: £335* Ground Rent: £200*

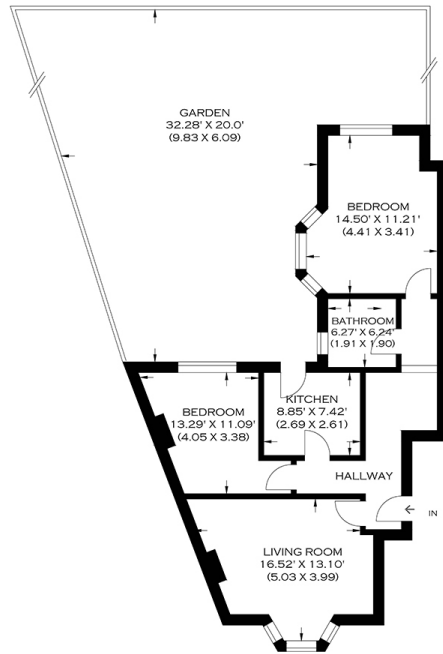

APPROXIMATE GROSS INTERNAL AREA
62.47 SQ M / 672 SQ FT

Rotherhithe & Bermondsey Office
146 Lower Road, London SE16 2UG

t: 020 7237 6767 e: rotherhithe@alexneil.com

Disclaimer: Property descriptions are subjective and used in good faith as an opinion rather than statements of fact. The owner provided information relating to title, tenure, service charges and ground rent information. Therefore, please make specific enquiries to ensure that our descriptions match your expectations of the property. Floor plan measurements are approximate and for illustrative purposes only. Furthermore, we have not tested any services, systems or appliances at this property. And we strongly recommend that you verify all the provided information on inspection and that your surveyor and conveyancer further confirm details. Also, market conditions and property values regularly fluctuate. And showcased sold properties demonstrate our previous successes rather than indicate live property values. *As advised by the owner. **Property sold subject to contract.



ALEX NEIL

ESTATE AGENTS SINCE 1984