



MUNDAY ROAD E16  
**3 bedroom end of terrace**

**£500,000**  
SOLD





# MUNDAY ROAD E16

This spectacular end-of-terrace house is in the highly sought-after Munday Road, Canning Town E16. The house is in pristine condition due to an extensive refurbishment, affording the perfect home to move straight into. The accommodation comprises two separate airy reception rooms, a smartly fitted kitchen with integrated appliances, three large double rooms, a modern designer bathroom and a downstairs shower room. This chain-free house also offers a large private garden, a private loft, ample storage and allocated parking. The house is on a quiet residential road, within easy reach of Custom House station, offering good transport links to Canary Wharf and the City. We recommend your earliest viewing.

Borough: Newham\* Council Tax: D\* EPC: TBA

Nearest Station: Royal Victoria (0.13 miles) Material Information: [www.alexneil.com/material-information](http://www.alexneil.com/material-information)

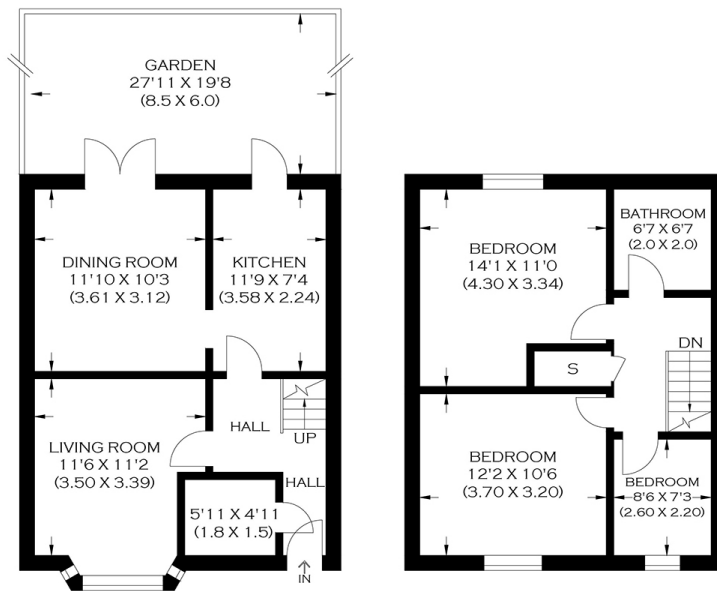

GROUND FLOOR

FIRST FLOOR

APPROXIMATE GROSS INTERNAL AREA  
84.69 SQ M / 911.59 SQ FT



**Canary Wharf & Docklands Office**  
2 Westferry Road, Canary Wharf, London E14 8JT

t: 020 7537 9859 e: [canarywharf@alexneil.com](mailto:canarywharf@alexneil.com)

Disclaimer: Property descriptions are subjective and used in good faith as an opinion rather than statements of fact. The owner provided information relating to title, tenure, service charges and ground rent information. Therefore, please make specific enquiries to ensure that our descriptions match your expectations of the property. Floor plan measurements are approximate and for illustrative purposes only. Furthermore, we have not tested any services, systems or appliances at this property. And we strongly recommend that you verify all the provided information on inspection and that your surveyor and conveyancer further confirm details. Also, market conditions and property values regularly fluctuate. And showcased sold properties demonstrate our previous successes rather than indicate live property values. \*As advised by the owner. \*\*Property sold subject to contract.

# ALEX NEIL

ESTATE AGENTS SINCE 1984

2024 signifies our **40th Anniversary**, and we are immensely proud to have reached this impressive longevity milestone. In celebration, we launched an **exceptional promotion** for sellers, affording them increased marketing exposure for free!

**40 years of expertise:** With four decades of experience, we bring a wealth of knowledge and expertise. Our durability is a testament to the trust satisfied clients place in us. We understand the nuances of the diverse neighbourhoods we cover. Our local expertise allows us to provide tailored solutions, whether you're buying or selling, allowing you to move with confidence.



ALEX NEIL

ESTATE AGENTS SINCE 1984

[www.alexneil.com](http://www.alexneil.com)