



LANGBOURNE PLACE E14
2 bedroom apartment

£375,000
SOLD



LANGBOURNE PLACE E14

Priced for a quick sale! This beautifully presented two bedroom apartment, idyllically located within the highly desirable gated development, Langbourne Place, Isle of Dogs E14 that borders the River Thames. This fantastic chain free apartment offers excellent living space and neutral decor throughout. Situated on the first floor, the property comprises of an open plan kitchen/lounge, master bedroom with sizable en-suite bathroom, second double bedroom and a stylish bathroom. Further benefiting from private gated parking. With Island Gardens DLR and The Greenwich Pier River Boat service both within easy reach, there are convenient travel connections across London. Canary Wharf is within easy reach and the trendy bars, shops and restaurants it encompasses.

Borough: Tower Hamlets* Council Tax: D* EPC: B Lease Term: 996* Service Charge: £2,400* Ground Rent: TBA

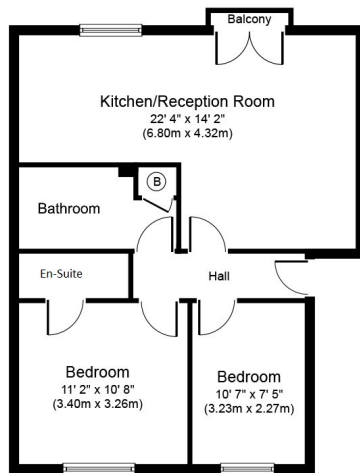

Approximate Floor Area
602 sq. ft.
(55.93 sq. m.)



Canary Wharf & Docklands Office
2 Westferry Road, Canary Wharf, London E14 8JT

t: 020 7537 9859 e: canarywharf@alexneil.com

Disclaimer: Property descriptions are subjective and used in good faith as an opinion rather than statements of fact. The owner provided information relating to title, tenure, service charges and ground rent information. Therefore, please make specific enquiries to ensure that our descriptions match your expectations of the property. Floor plan measurements are approximate and for illustrative purposes only. Furthermore, we have not tested any services, systems or appliances at this property. And we strongly recommend that you verify all the provided information on inspection and that your surveyor and conveyancer further confirm details. Also, market conditions and property values regularly fluctuate. And showcased sold properties demonstrate our previous successes rather than indicate live property values. *As advised by the owner. **Property sold subject to contract.

ALEX NEIL

ESTATE AGENTS SINCE 1984