



RIVERWAY HOUSE E14  
**1 bedroom apartment**

**£300,000**  
SOLD





# RIVERWAY HOUSE E14

A unique apartment, located within the highly desirable Burrells Wharf, one of the few Grade II listed Developments in Canary Wharf. This superb apartment comprises a large lounge, separate kitchen with fully fitted appliances, a double bedroom and a modern three piece bathroom. The property benefits from a residents gymnasium, swimming pool and a 24-hour concierge service. Riverway House is perfectly positioned for swift access to Canary Wharf and the vast selection of shops, restaurants and bars it encompasses. This is ideal for professionals looking for a characterful, well placed home.

Borough: Tower Hamlets\* Council Tax: C\* EPC: E Lease Term: TBA Service Charge: TBA Ground Rent: TBA

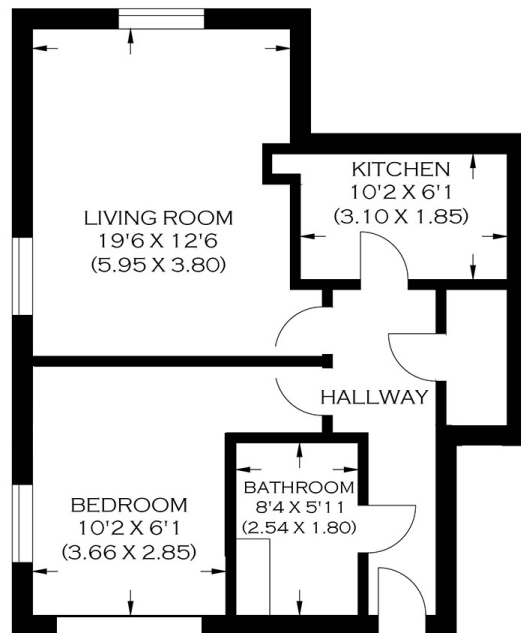

APPROXIMATE GROSS INTERNAL AREA  
51.65 SQ M / 555.95 SQ FT

**Canary Wharf & Docklands Office**  
2 Westferry Road, Canary Wharf, London E14 8JT

t: 020 7537 9859 e: [canarywharf@alexneil.com](mailto:canarywharf@alexneil.com)

Disclaimer: Property descriptions are subjective and used in good faith as an opinion rather than statements of fact. The owner provided information relating to title, tenure, service charges and ground rent information. Therefore, please make specific enquiries to ensure that our descriptions match your expectations of the property. Floor plan measurements are approximate and for illustrative purposes only. Furthermore, we have not tested any services, systems or appliances at this property. And we strongly recommend that you verify all the provided information on inspection and that your surveyor and conveyancer further confirm details. Also, market conditions and property values regularly fluctuate. And showcased sold properties demonstrate our previous successes rather than indicate live property values. \*As advised by the owner. \*\*Property sold subject to contract.



## ALEX NEIL

ESTATE AGENTS SINCE 1984